

Decommissioning instructions available to enable responsible recycling or disposal

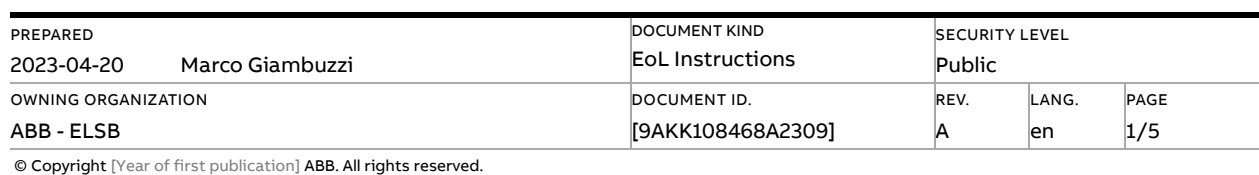

Contents

1. Purpose and Basic Description	3
2. Dismantling instructions	3
2.1.1. Electronic Board	4
3. Constituent materials	5
4. Additional Information.....	5

1. Purpose and Basic Description

This product family is in the scope of European Union directive 2012/19/EU on Waste Electrical and Electronic Equipment (WEEE). The product family must be disposed according to the legislation of the country. This the end-of-life instructions is intended for use by customers and recycling companies which outline the responsible recycling or disposal method of the ABB product.

SX-ARC1 is designed to be used in residential and light commercial applications to protect against short-circuits, overload and series, parallel and earth arc fault.

2. Dismantling instructions

First step: the label and the rail clip should be removed to split the various cover of product.

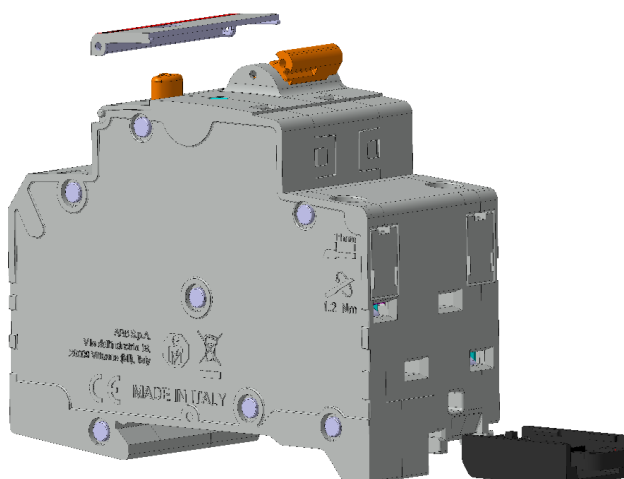

Second step: removed the rivets (7 rivets), the calibration screw and the terminal protection, then you will be able to take out the covers and access to all the internal parts.

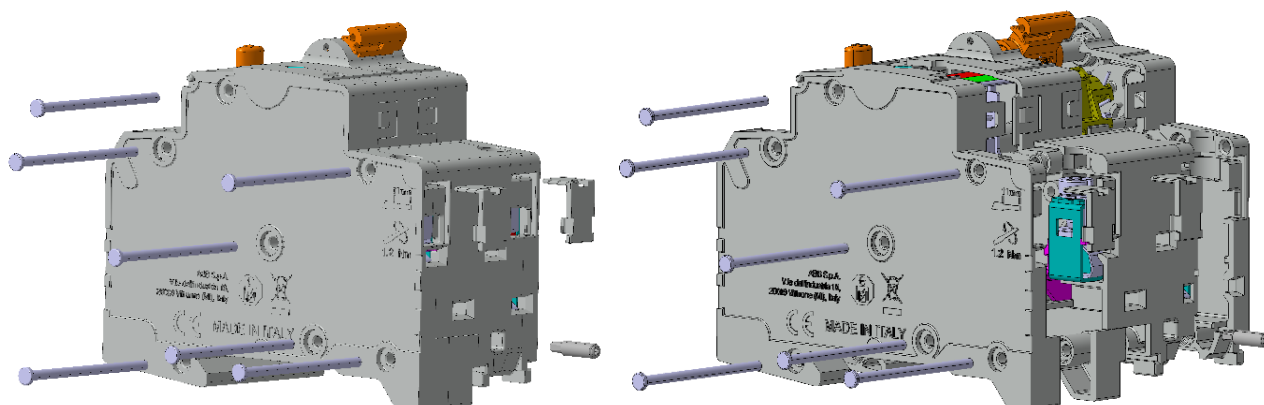

The different parts will be extracted until reaching the configuration of the figure below.

*Rounded parts have soldered or riveted pieces that cannot be manually disassembled.

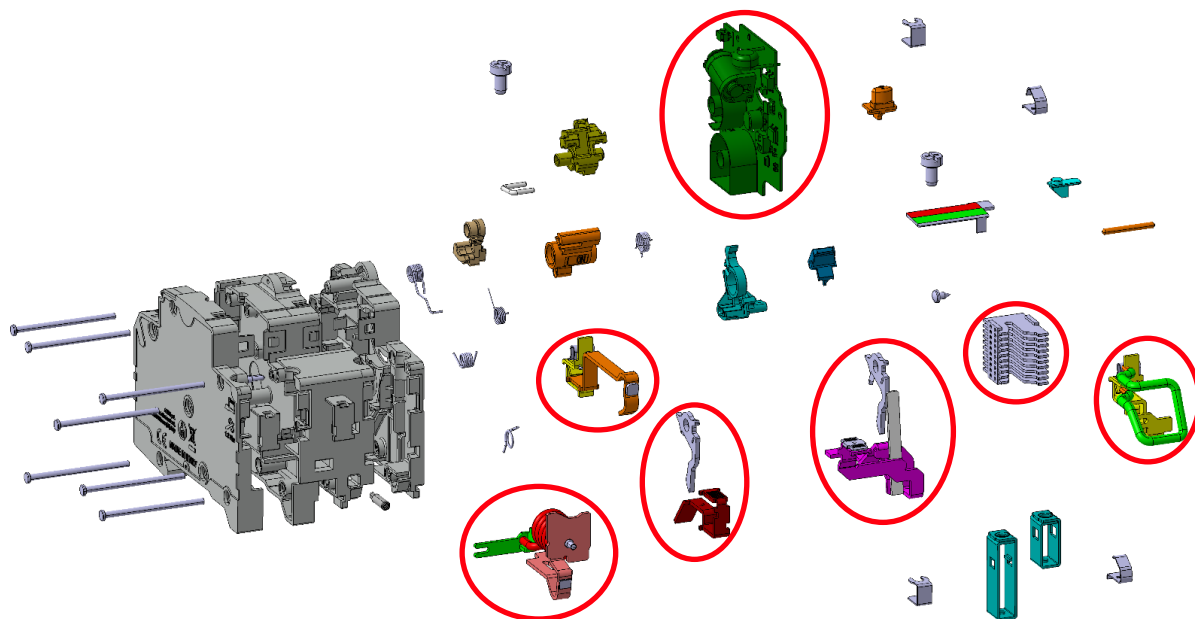

2.1.1. Electronic Board

At the end, the Electronic Board must be depolluted to assure an appropriate end of life treatment.

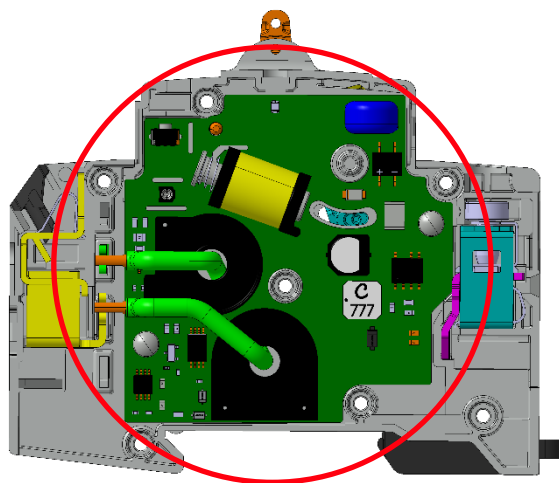

Weight of the Electronic Board = 25 g

3. Constituent materials

Plastics		Metals		Packaging	
PA6 + GF	37.1%	Steel	23.7%	Cardboard	6.7%
PA	0.2%	Copper	8.6%	PE	0.2%
PC	0.4%	Aluminum	1%		
Others	2.1%	Others	14.9%		

*% of total weight for one pole + Neutral.

4. Additional Information

Weight per 1 Pole + Neutral	170g
Overall dimensions (H x D x W)	85 ⁽¹⁾ x 67.6 x 35.2 mm
Recyclability rate	41.3%

⁽¹⁾ Without considering rail clip