

## TECHNICAL DATA SHEET

**PMA Accessories - GPS-SP - Welding plate**

Welding plate for system support

**PMA****CE UK  
CA****Applications:**

- In combination with system support GPS

**Features & Benefits:**

- For fixation of the one-piece system supports BGPS
- For reinforcement of the base plate or if no bore holes can be drilled
- Increases the retention force of system support BGPS

**Compatible with:**

- PMA System Support BGPS

**Product selection:**

Part no.	Conduit size	Dimensions in mm (nom.)				Weight	Packing unit
		A	B	L2	L		
	NW					kg/100 pcs	pcs/PU
GPS-SP <sup>17/23</sup> -ST	17 + 23	30.0	10.0	44.8	70.0	15.7	10
GPS-SP <sup>29/36</sup> -ST	29 + 36	30.0	10.0	59.7	80.0	19.4	10
GPS-SP <sup>48/56</sup> -ST	48 + 56	30.0	10.0	89.5	110.0	26.2	10

Our customer service dept. or local distribution partner will be pleased to help you concerning product availability and lead time

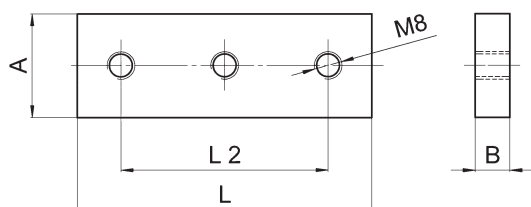
**Content of delivery:**

- Welding plate without screws

**Assembly instructions:**

- The one-piece system support GPS can be fixed on the welding plate using screws or threaded bolts.

ABB Switzerland Ltd,  
PMA Cable Protection  
Aathalstrasse 90  
8610 Uster, Switzerland  
Phone: +41 58 585 00 11  
pma-info@ch.abb.com  
www.pma.ch

Let's write the future.  
Together. **abb.com**

We reserve the right to make technical changes or modify the contents of this document without prior notice. With regard to purchase orders, the agreed particulars shall prevail. ABB Installation Products Inc. does not accept any responsibility whatsoever for potential errors or possible lack of information in this document.

We reserve all rights in this document and in the subject matter and illustrations contained therein. Any reproduction, disclosure to third parties or utilization of its contents – in whole or in parts – is forbidden without prior written consent of ABB Inc. Copyright© 2019 ABB Installation Products Inc. All rights reserved

