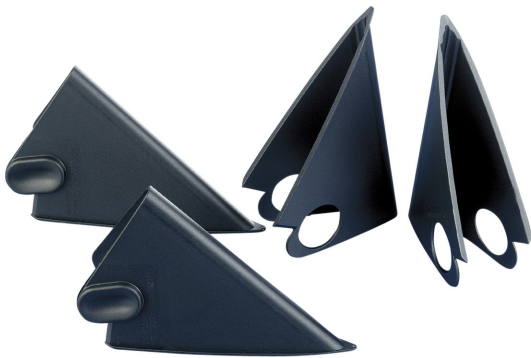

TECHNICAL DATA SHEET**PMA Accessories - EWZ - Draw-in tool**

Draw-in tool for wires/cables

PMA**CE UK
CA****Applications:**

- Can be used whenever a drawing-in assistance for slit and divisible conduits is helpful

Features & Benefits:

- Easy draw-in for single and several cables/wires suitable for slit conduits or PMA Divisible System conduits
- Designed in a handy shape
- Equipped with a practical hand grip for clamping or with hole for direct holding of the wires

Materials:

- Specially formulated polyamide 6.6

Compatible with:

- slit PMA conduits, PMA Divisible System conduits

Colour:

- Black

Chemical properties:

- Please refer to www.pma.ch

Product selection:							
Part no.		Conduit size	Dimensions in mm (nom.)			Weight	Packing unit
with hole design	with handle design	NW	L	H	B	kg/100 pcs	pcs/PU
EWZ-02	EWZ-03	7.5 - 34	117.7	71.9	45.2	1.2	100/50

Our customer service dept. or local distribution partner will be pleased to help you concerning product availability and lead time

with hole:

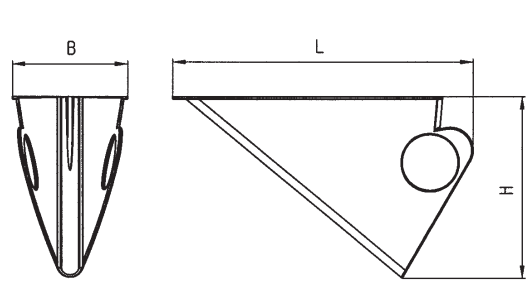

with handle:

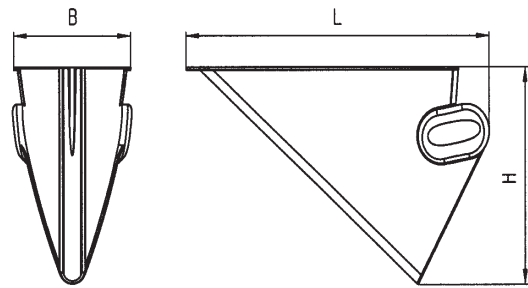

handling

Insert cables or wires into the channel of the draw-in tool.



Clamp cables or wires with grip or hold them directly through the hole. Pull the slit or divisible conduit from the grip area over the lugs.

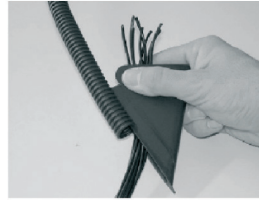

During passing through the cables or wires, hold them with one hand and do not let go the slit conduit with the other hand.

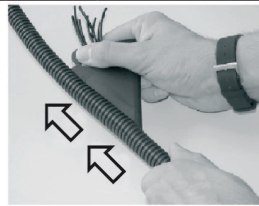

Remove the draw-in tool after of cables or wires ...



... finished

