

Signal products

Example systems

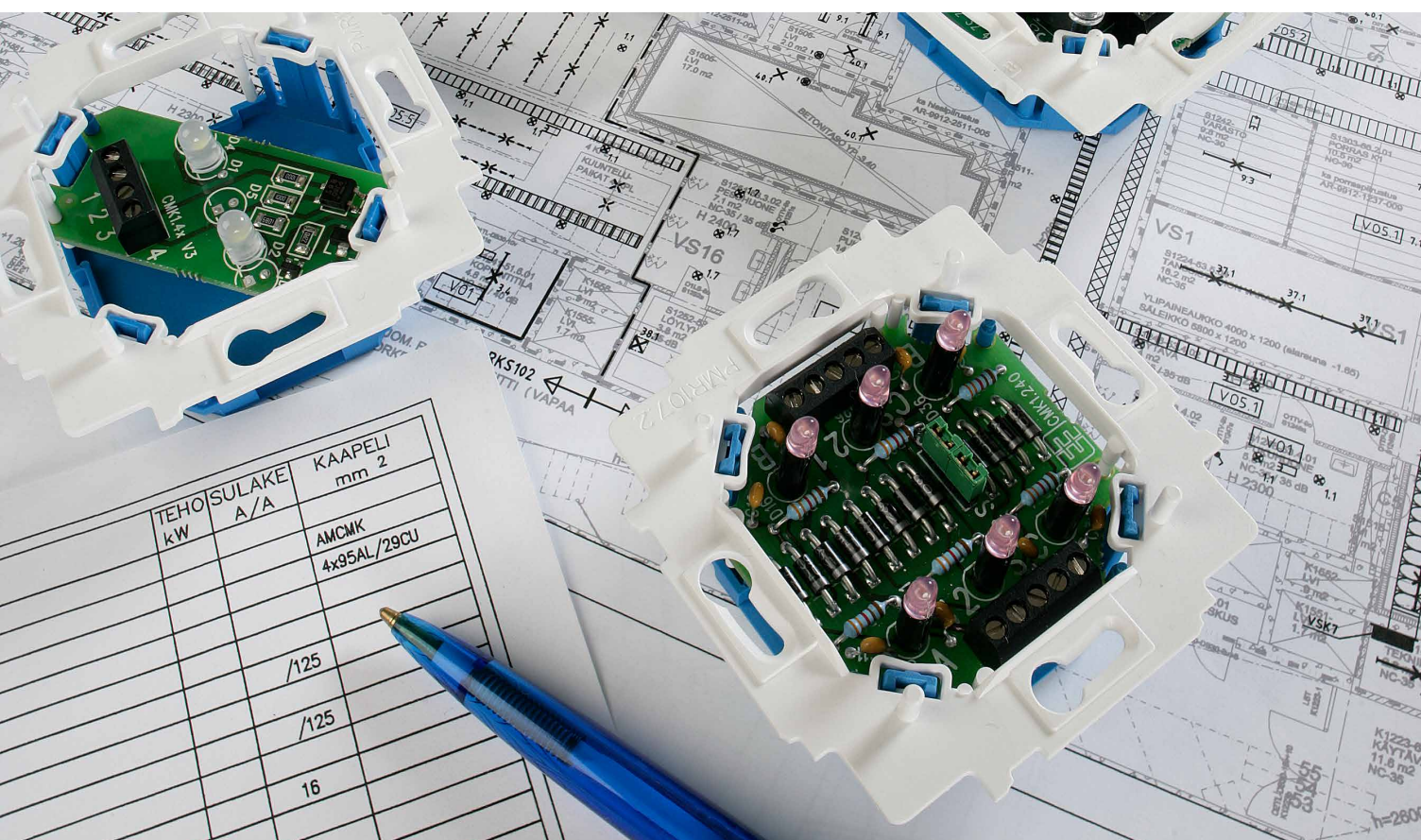

- Applications that are always convenient and efficient
- Creating applications through various combinations of basic functions
- Can be expanded to the free@home and KNX systems

Contents

04	Leak guard
	Accessible toilet alert system
06	Accessible toilet alarm (FEH1001)
08	Accessible toilet alarm (FEH1001) with follow-up alert
10	Accessible toilet alarm (FEH2001)
12	Accessible toilet alarm (FEH2001) with follow-up alert
	Office systems
14	Busy light 24V
16	Busy light 230V
	Emergency call systems
18	Service home assistance request
20	Public building emergency alarm

Purpose and function

The leak guard can monitor the possible water leakage from dishwashers, hot water heaters or any other machine or equipment. When properly installed, the leak guard will report water leakage before it can be detected by other means.

When water or moisture appears between correctly installed sensor wires, a small current starts to flow between the wires. The leak guard detects the current and triggers an alarm. The leak guard light starts flashing and the indicator light / buzzer / beeper is triggered. The alarm can be silenced with the silencer button on the unit. However, the light of the leak guard remains on without blinking until there is no more moisture between the sensor wires.

The leak guard has two function selectors, "M" and "R", which can be used to adjust the unit's functioning.

The leak guard controls the leakage current passing through the sensor. Increasing the number of sensors increases the leakage current rate, making the alarms more responsive.

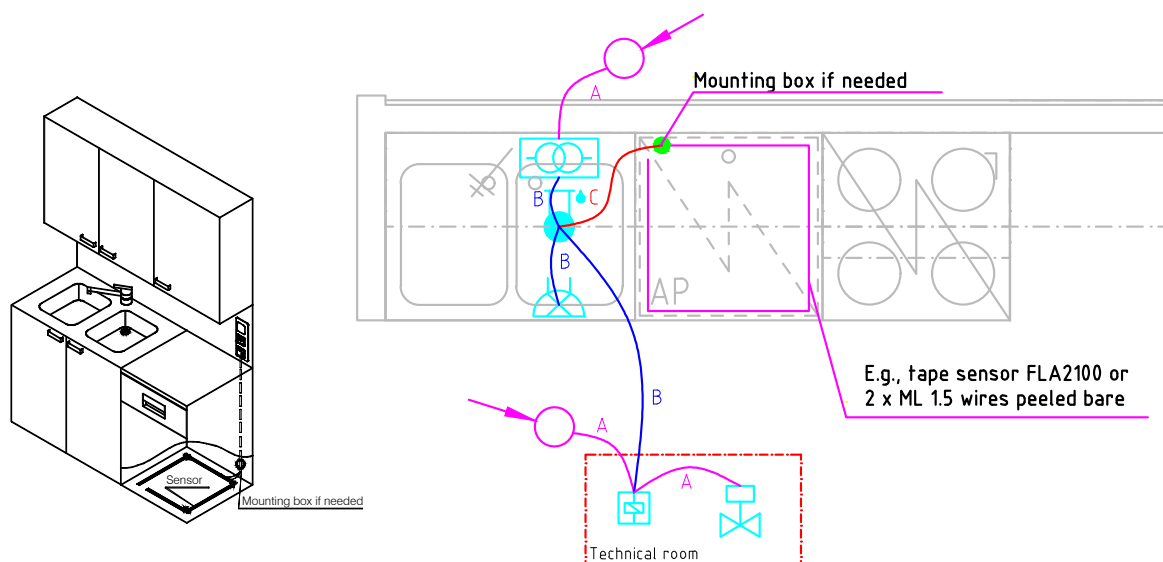

WIRING: A = E.G. MMJ 3 x 1,5S
 B = E.G. MHS 1 x 4 x 0,5
 KLM 4 x 0,8
 KLMA 4 x 0,8 + 0,8
 C = Wound pair of wires
 E.G. CAT5



Leak guard
 FEH2100 EAN: 6410070607131



Alarm
 FIM1200 EAN: 6410070607520



Transformer 230V / 15V / 2VA
 FLM1000 EAN: 6410070607650



Supplementary relay
 FIR1000 EAN: 6410070607803



Magnetic valve

Sensor

Suitable sensors for the leak guard are tape sensor FLA2100 or any other uninsulated pair of semiconductor cables isolated from each other. Please note that the insulation mustn't be watertight. For example, the sensor can be made using two ML 1.5 wires with the coating peeled off around the monitored area, which are then attached to the floor under a dishwasher with suitable screws, nails, fasteners or gluing points. During the installation, note that any humidity or water to be detected will have to touch both wires simultaneously.

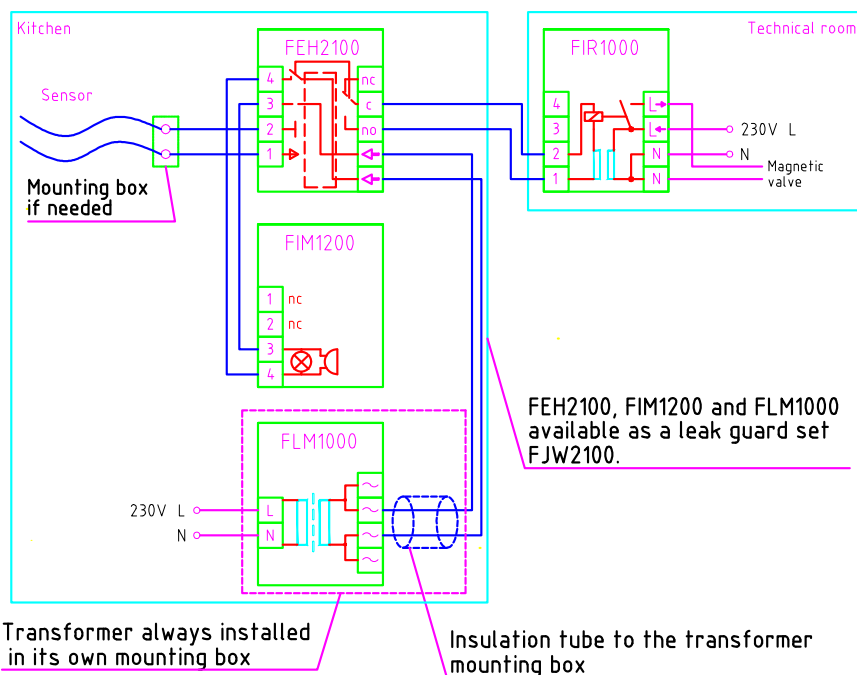

Function selector "M" (memory function):

- When the selector is set to "-", the memory function is inactive. The alarm disappears when there is no longer any moisture between the wires.
- When the selector is set to "M", the alarm will not disappear until manual reset, even when there is no longer any moisture.

Function selector "R" (magnetic valve control):

- When the selector is set to "OFF" (the prongs are short-circuited), the alarm reset releases the magnetic valve.
- When the selector is set to "ON" (the prongs are not short-circuited), the magnetic valve is released only after the alarm is acknowledged and the sensor is dry.

Note!

If an operator switch is used in the feeder circuit, all poles must be disconnected. Accidental disconnection of the system must be prevented.

Purpose and function

This system is designed for WC facilities for people with reduced mobility and others in need of assistance.

When the alarm button is pressed or the pullcord is pulled, the indicator light outside the WC facilities will blink and the buzzer will sound intermittently. Each button has an indicator light that lets the user know that the request for assistance has been successfully made. The alert remains in effect until it is reset with the button beside the WC door.

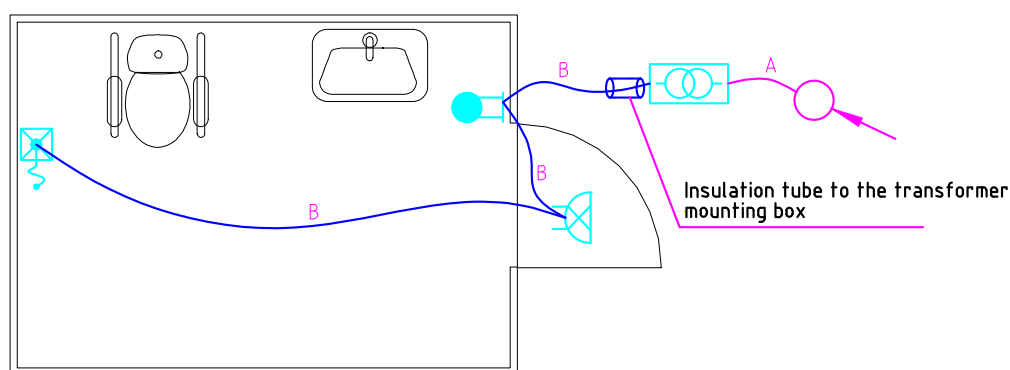

WIRING:

A = E.G. 2x1,5

B = E.G.

MHS 1 x 4 x 0,5

KLM 4 x 0,8

KLMA 4 x 0,8 + 0,8



Pullcord button
FAP3002 EAN: 6410070607261

- The cord must be left long enough to touch the floor



Alarm
FIM1200 EAN: 6410070607520

- Installation above the WC door on the outside



Control unit
FEH1001 EAN: 6410070607117

- Control unit with reset button



Transformer 230V / 15V / 2VA
FLM1000 EAN: 6410070607650

- Transformer always installed in its own mounting box

- Double protective insulation between the primary and secondary coils is ensured by a protective tube

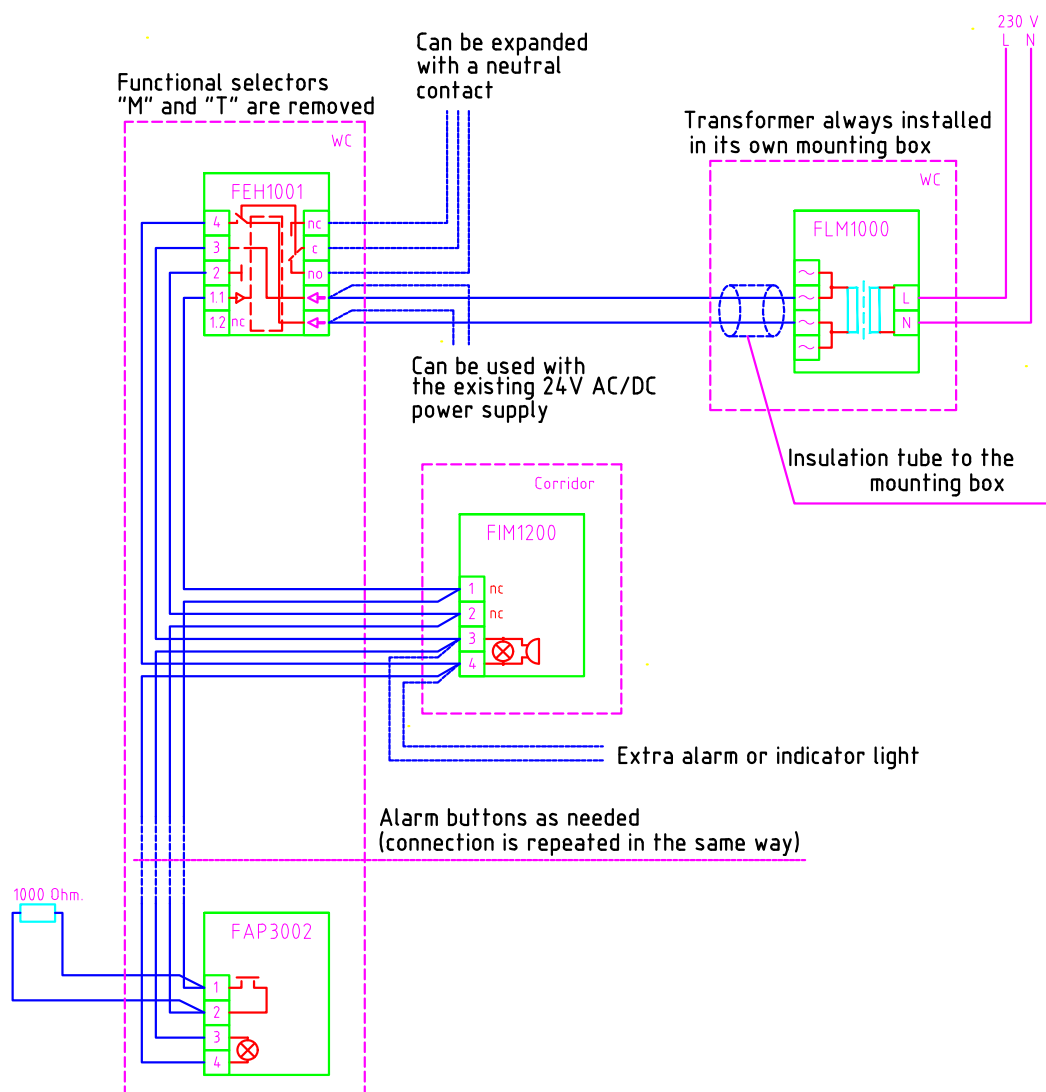

Note! If an operator switch is used in the feeder circuit, all poles must be disconnected. Accidental disconnection of the system must be prevented.

Purpose and function

This system is designed for WC facilities for people with reduced mobility and others in need of assistance. In addition, the system has a light panel that can centrally detect alerts

When the alarm button is pressed or the pullcord is pulled, the indicator light outside the WC facilities will blink and the buzzer will sound intermittently. The indicator light can detect which WC the alert is coming from and it has a buzzer that can be reset with the button. The alert remains in effect until it is reset with the button beside the WC door.

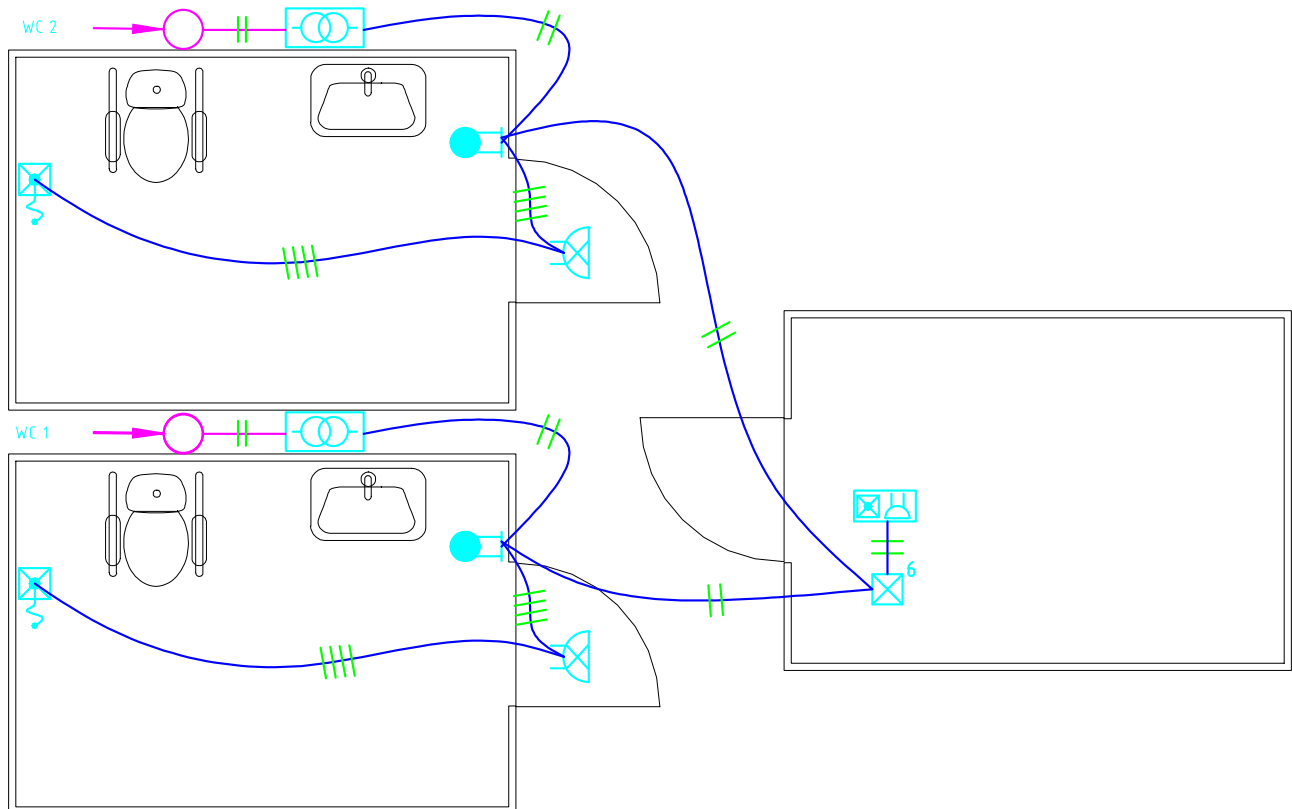

Pullcord button
FAP3002 EAN: 6410070607261

- The cord should be left long enough to touch the floor



Alarm
FIM1200 EAN: 6410070607520

- Installation above the WC door on the outside



Control unit
FEH1001 EAN: 6410070607117

- Control unit with reset button



Transformer 230V / 15V / 2VA
FLM1000 EAN: 6410070607650

- Transformer always installed in its own mounting box
- Double protective insulation between the primary and secondary coils is ensured by a insulation tube



Button / buzzer
FIP1011 EAN: 6438199005225

- Buzzer with push button



Indicator light panel
FIM1300 EAN: 6410070607537

- Six indicator lights

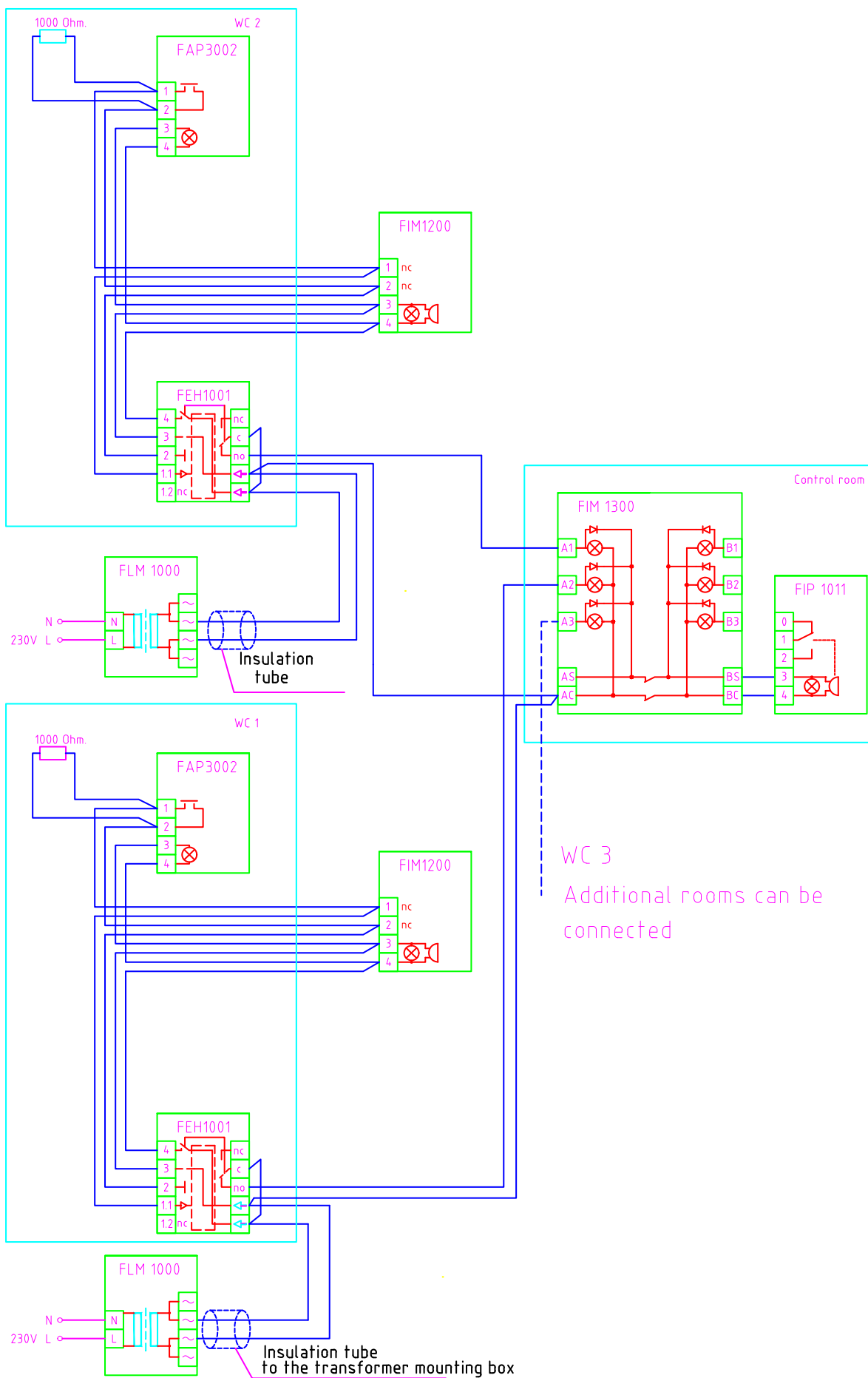

This system is designed for WC facilities for people with reduced mobility and others in need of assistance.

When the alarm button is pressed or the pullcord is pulled, the indicator light outside the WC facilities will blink and the buzzer will sound intermittently. Each button has an indicator light that lets the user know that the request for assistance has been successfully made. The alert remains in effect until it is reset with the button beside the WC door.





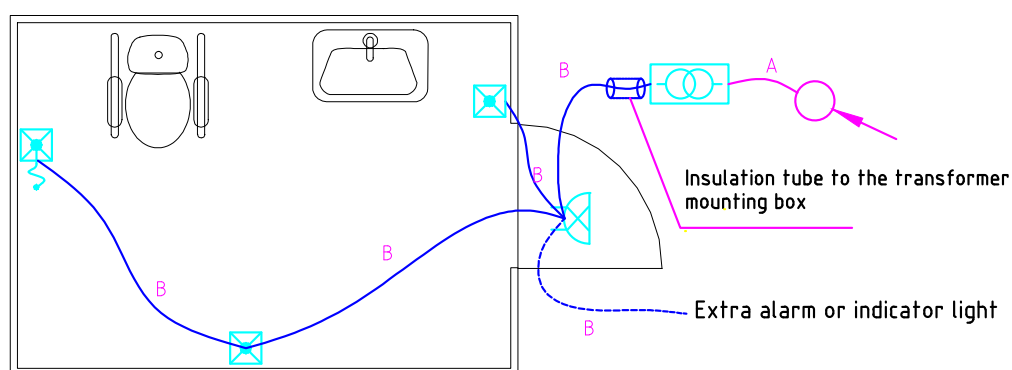





The necessary products for the disabled WC emergency call system are also available as a set with one EAN code.

-JUSSI	Disabled WC set	FJW1004	EAN: 6418677332012
-IMPRESSIVO	Disabled WC set	FJW1004-84	EAN: 6438199002934



WIRING:

A = E.G.	2x1,5
B = E.G.	MHS 1 x 4 x 0,5 KLM 4 x 0,8 KLMA 4 x 0,8 + 0,8

		Button FAP2001 EAN: 6410070607216	- At least one call button at the floor boundary
		Pullcord button FAP3002 EAN: 6410070607261	- The cord should be left long enough to touch the floor
		Reset button FAP2001 EAN: 6410070607216	
		Alarm, single-loop FEH2001 EAN: 6410070607179	
		Transformer 230V / 15V / 2VA FLM1000 EAN: 6410070607650	<ul style="list-style-type: none"> - Transformer always installed in its own mounting box - Double protective insulation between the primary and secondary coils is ensured by an insulation tube

JUSSI set

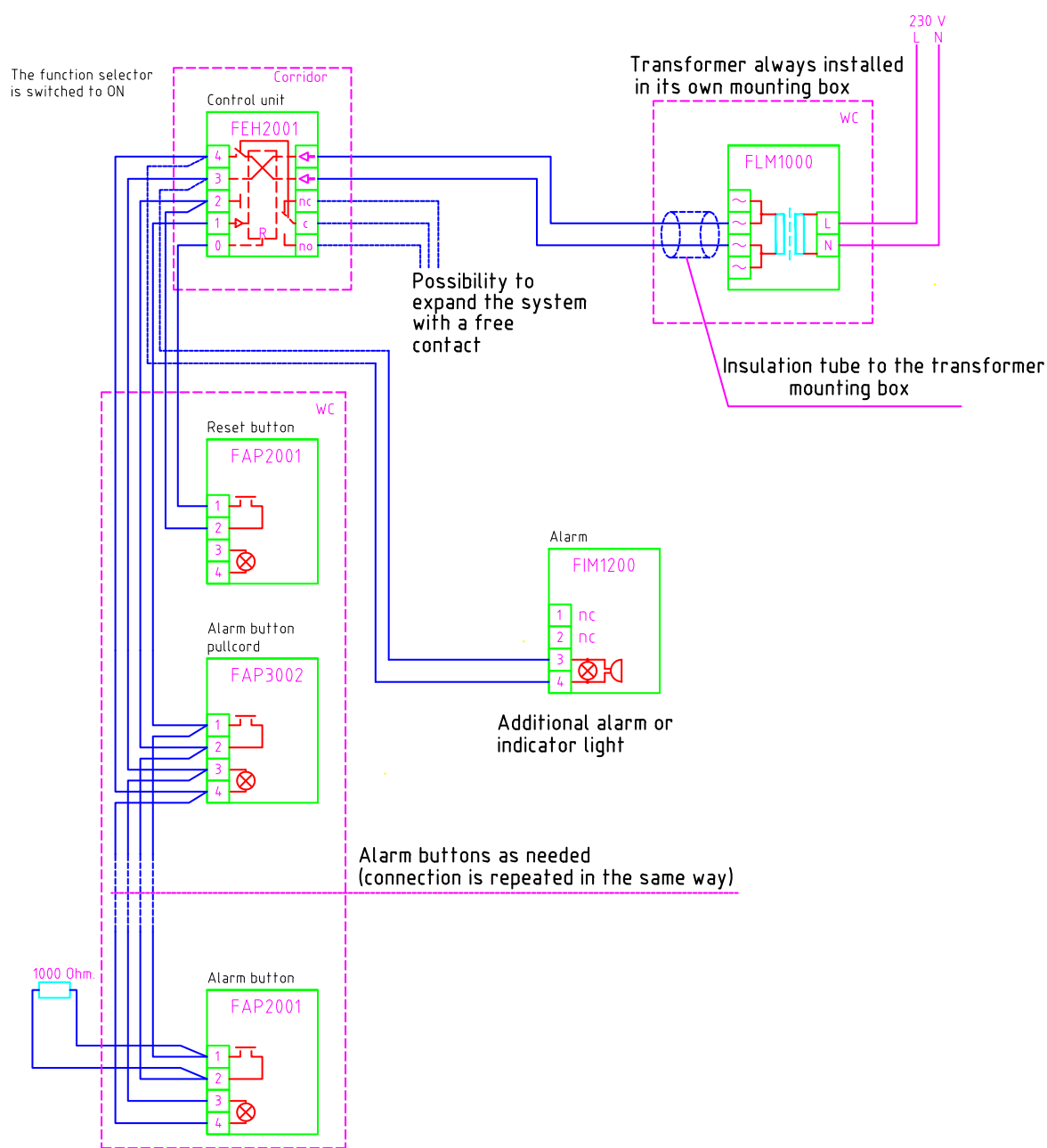

Note!

If an operator switch is used in the feeder circuit, all poles must be disconnected. Accidental disconnection of the system must be prevented.

Purpose and function

This system is designed for WC facilities for people with reduced mobility and others in need of assistance.

When the alarm button is pressed or the pullcord is pulled, the indicator light outside the WC facilities will blink and the buzzer will sound intermittently. The indicator light can detect which WC the alert is coming from and it has a buzzer that can be reset with the button. Each button has an indicator light that lets the user know that the request for assistance has been successfully made. The alert remains in effect until it is reset with the button beside the WC door.

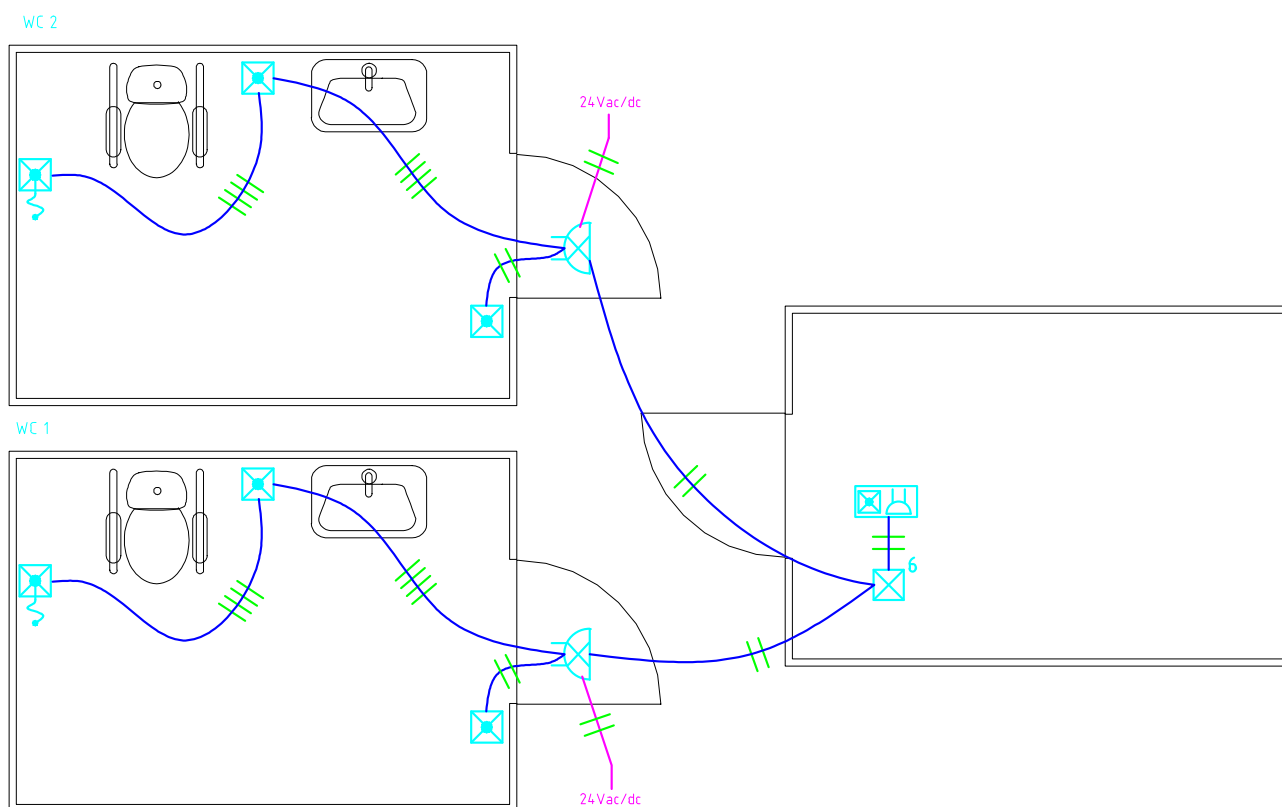

Button
FAP2001 EAN: 6410070607216

- At least one call button at the floor boundary



Pullcord button
FAP3002 EAN: 6410070607261

- The cord should be left long enough to touch the floor



Alarm, single-loop
FEH2001 / EAN: 6410070607179



Indicator light panel
FIM1300 / EAN: 6410070607537



Button / buzzer
FIP1011 / EAN: 6438199005225

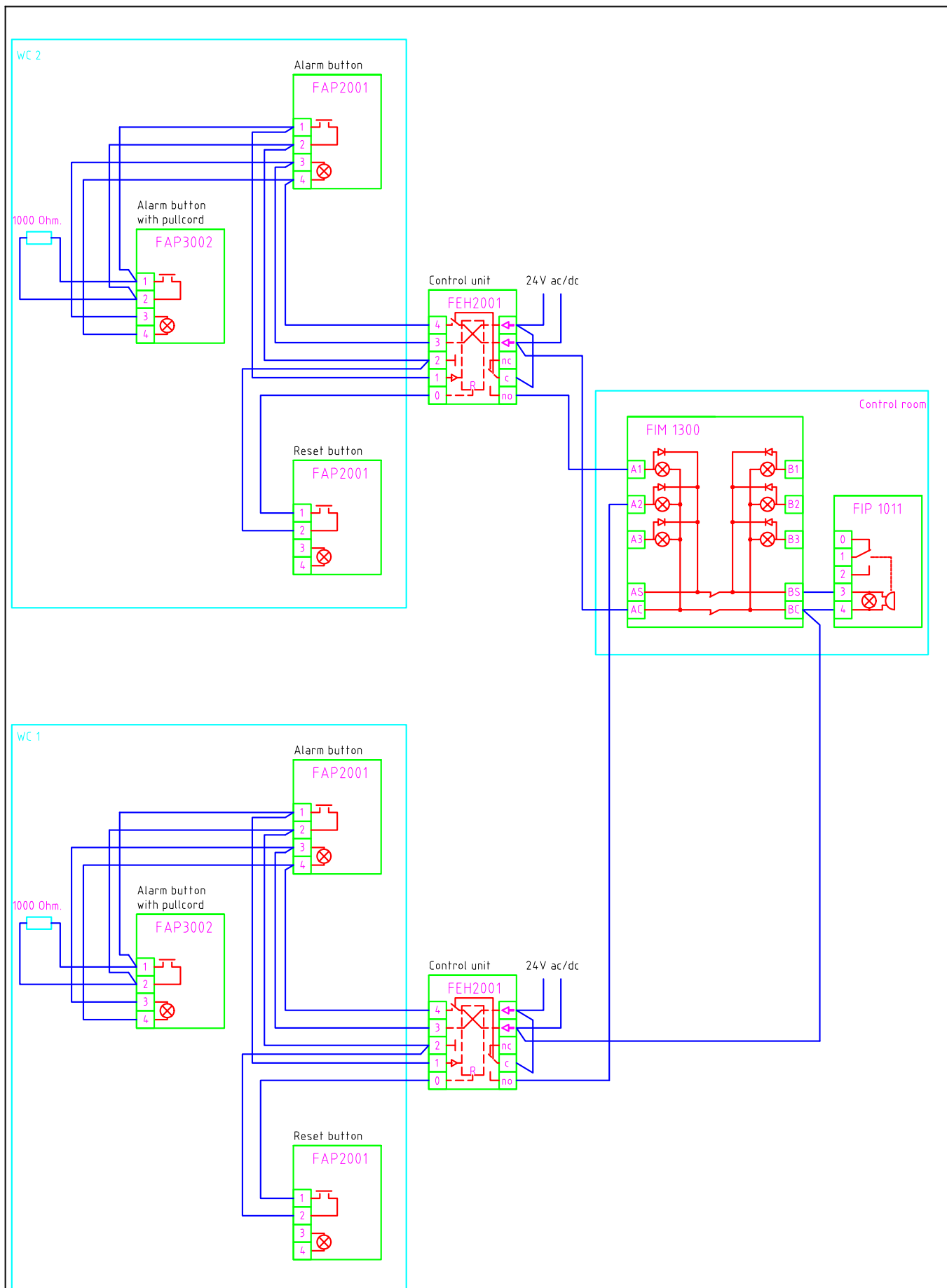

Purpose and function

The Busy light can be used as a “Do not disturb” indicator for example for conference rooms. The LED indicator light outside the room can be controlled with a switch inside the room.

WIRING: B = E.G. MHS 1 x 4 x 0.5 A = E.G. MMJ 3 x 1.5S

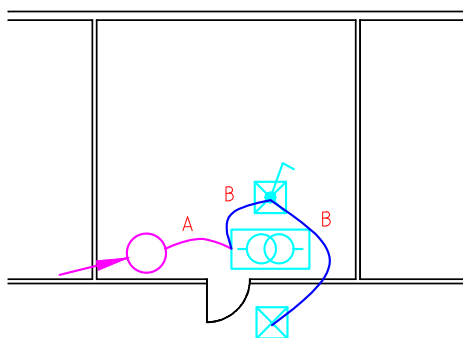

Transformer 230V / 15V / 2VA
FLM1000 / EAN: 6410070607650



Indicator light
FIM1000 EAN: 6410070607513



Switch
FAK1021 EAN: 6438199005218

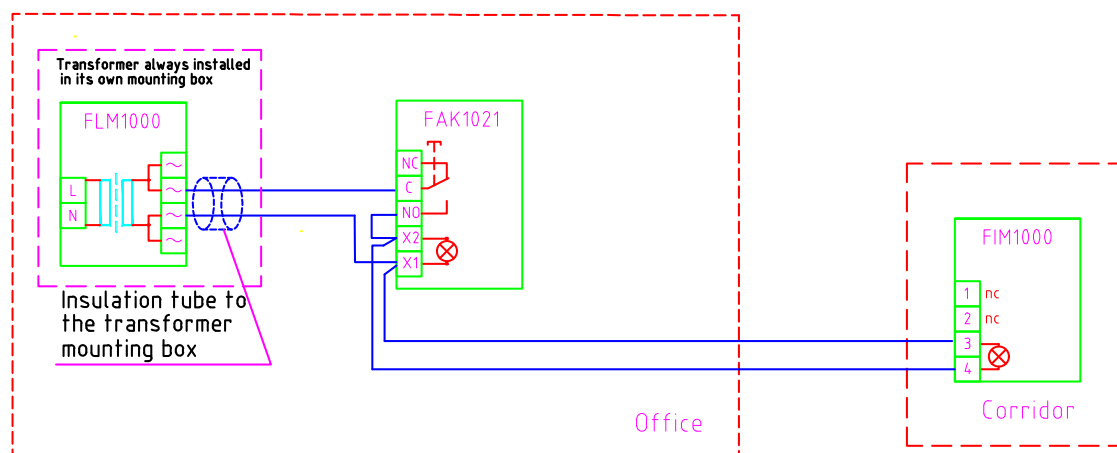

Note! If an operator switch is used in the feeder circuit, all poles must be disconnected. Accidental disconnection of the system must be prevented.

Purpose and function

The Busy light can be used as a “Do not disturb” indicator for example for conference rooms. A switch inside the room can be used to turn on the outside LED indicator.

WIRING: A = E.G. MMJ 3 x 1.5S

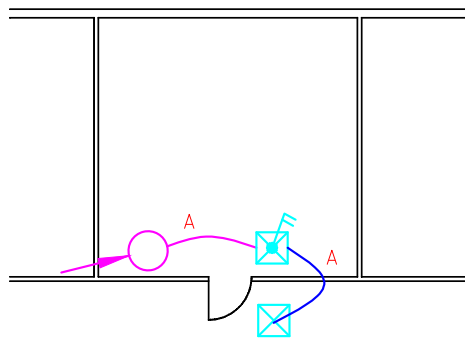

2-switch

1062UC-84 EAN: 6438199001180

8370R EAN: 6438199004860



Indicator light

2661.02 EAN: 6418677334382

V-84 EAN: 6418677330100

Wiring with 2 switch

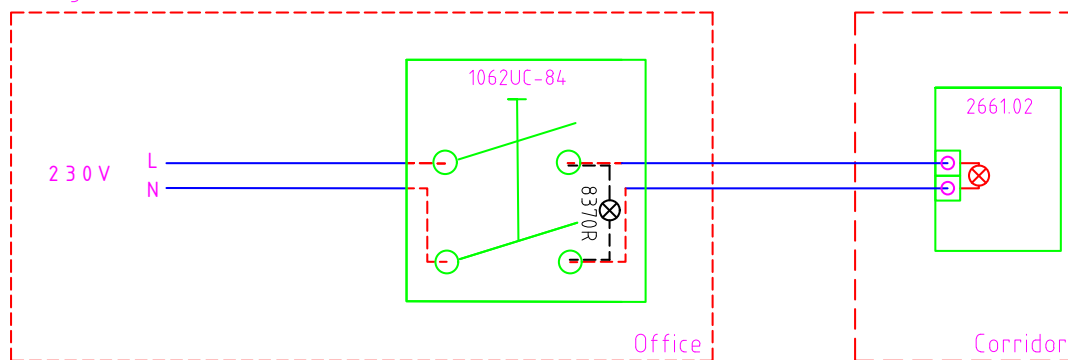

Note!

If an operator switch is used in the feeder circuit, all poles must be disconnected. Accidental disconnection of the system must be prevented.

Purpose and function

An assistance request system for elderly people home or assisted living with room-specific or area-specific buttons for assistance requests. The caregiver receives alerts in the indicator light panel in the office.

Each room is equipped with alarm buttons at the appropriate locations. The alerts are centrally managed. When an alarm is sounded, the buzzer sounds and the indicator light panel indicates the location of the alert. Once the alert has been verified, the buzzer can be silenced with the reset button. After verification, the alert is reset using the reset button in the room where the alert was triggered.

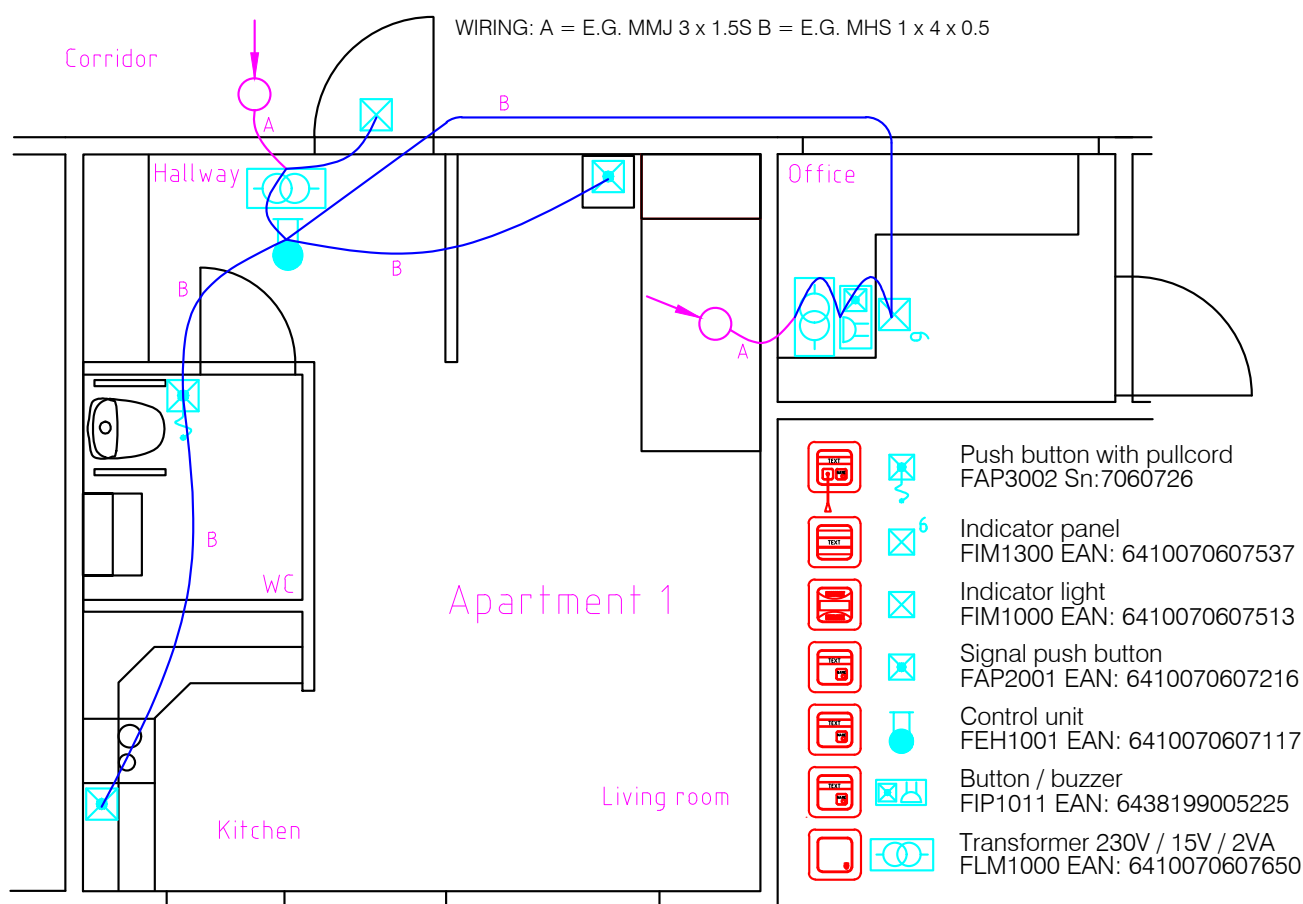

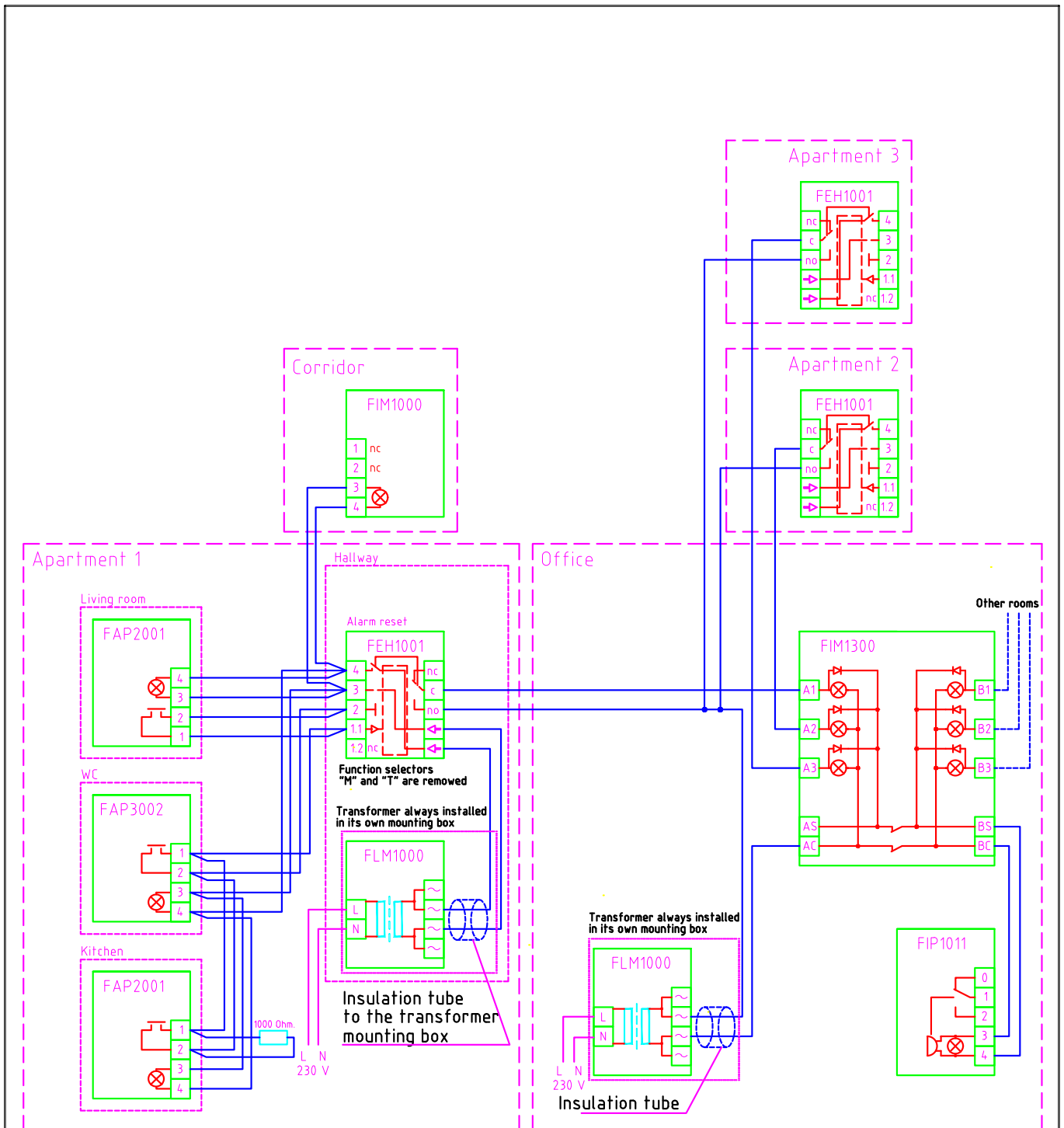







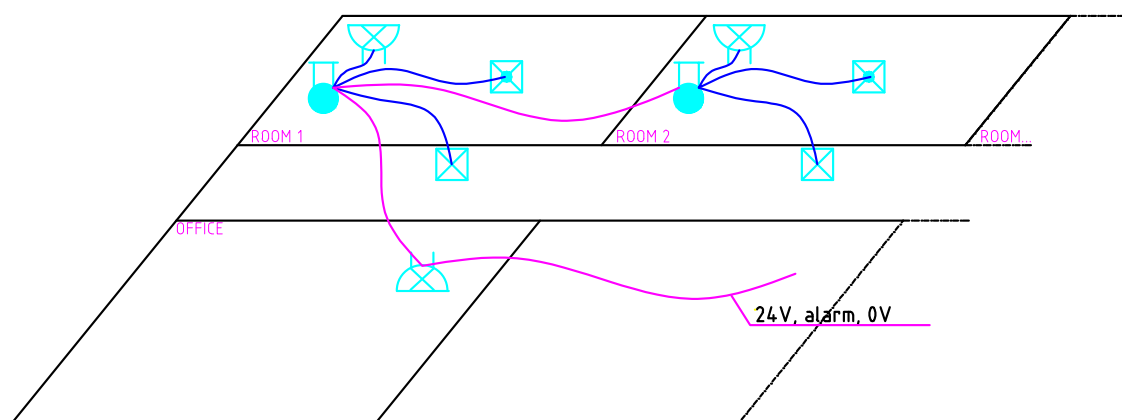

Purpose and function

The emergency alarm system is highly suitable for basic protection against threats for employees in public buildings and offices.

Each room has two alarms, one on the inside and the other outside the room. When the alarm button is pressed in the room, a warning light is activated outside the room. Nothing happens inside the room. Simultaneously, the alarm is sounded within the other office to alert colleagues that help is needed. The alarm is acknowledged with the reset button in the room. The alarms can also be installed in other areas as necessary.



WIRING: MHS 1 x 4 x 0,5 or NOMAK 2 x 2 x 0,5 or KLM 4 x 0,8

		Indicator light FIM1000 EAN: 6410070607513
		Signal push button FAP2001 EAN: 6410070607216
		Alarm FIM1200 EAN: 6410070607520
		Control unit FEH1001 EAN: 6410070607117

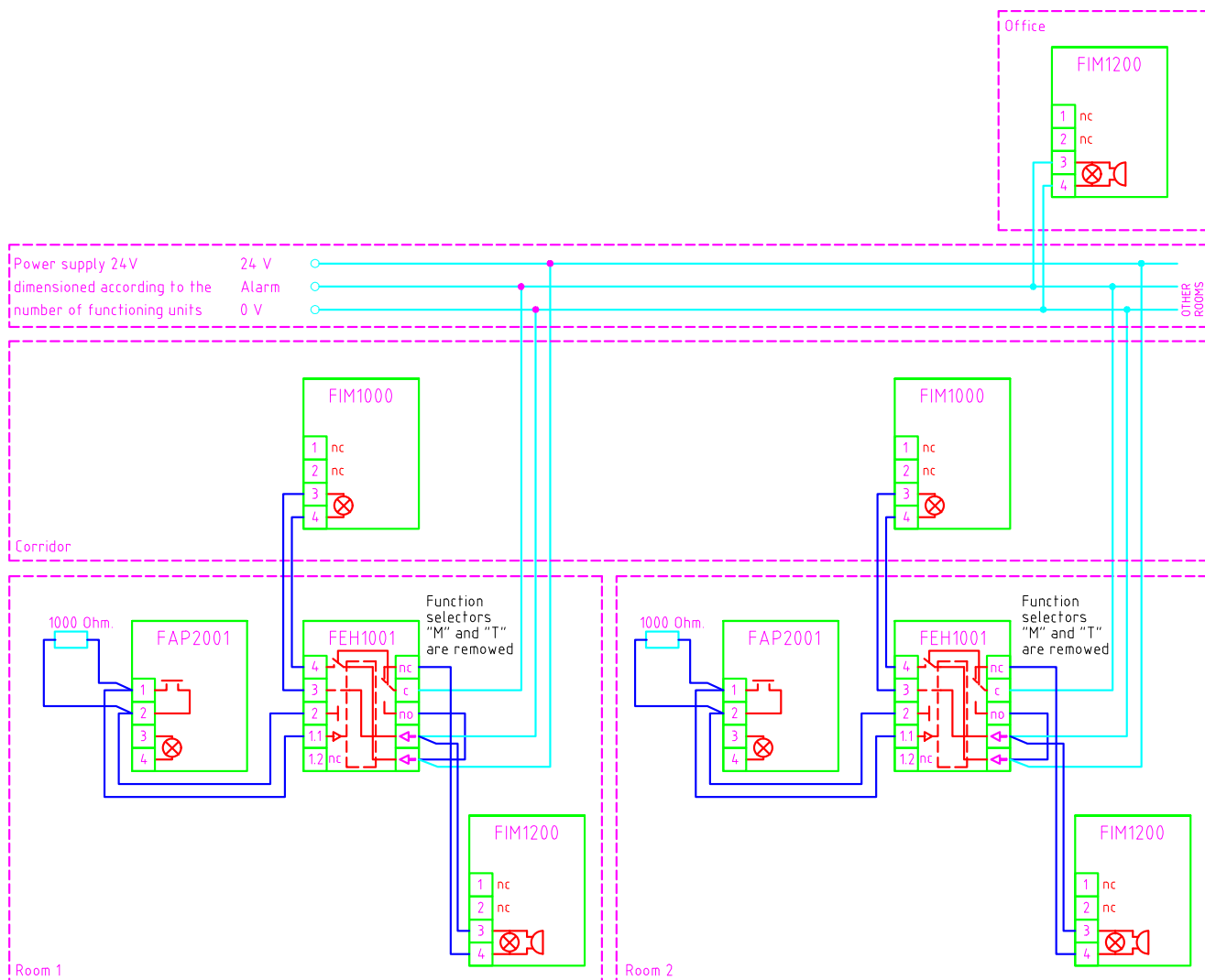

Additional information

Our website provides more information on products and applications.

www.installationmaterials.com

- Product information
- Example systems (CAD, DXF, PDF)
- Wiring diagrams
- Dimensional drawings
- Installation instructions
- Presentations
- References
- Marking program for printing
- Product basket (download the collected products in an Excel file)

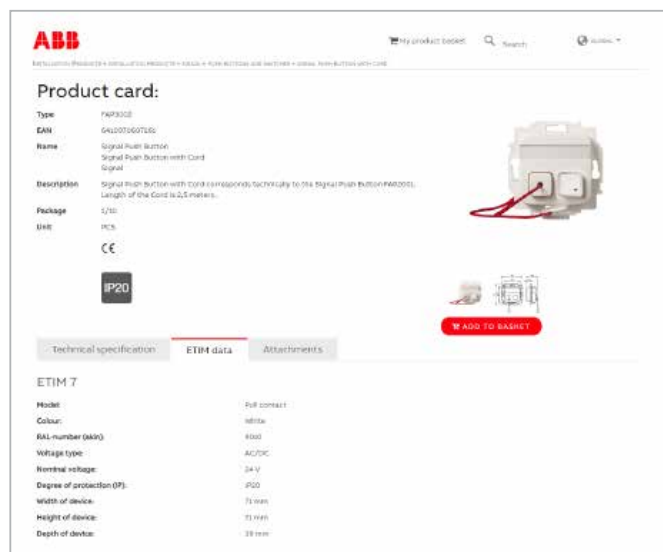

Product card

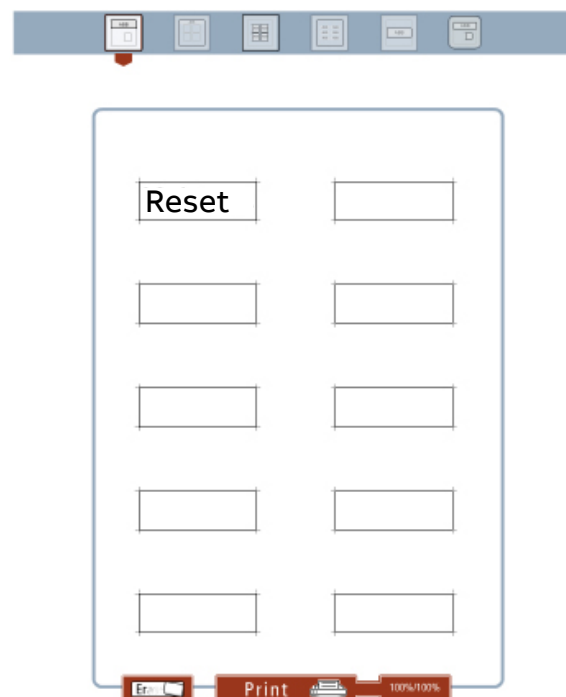

Marking program



—

ABB Oy

P.O. Box 16 (Porvoon Sisäkehä 2)
FI-06101 Porvoo, Finland
Customerservice.WA@abb.fi.com

abb.com

installationmaterials.com