

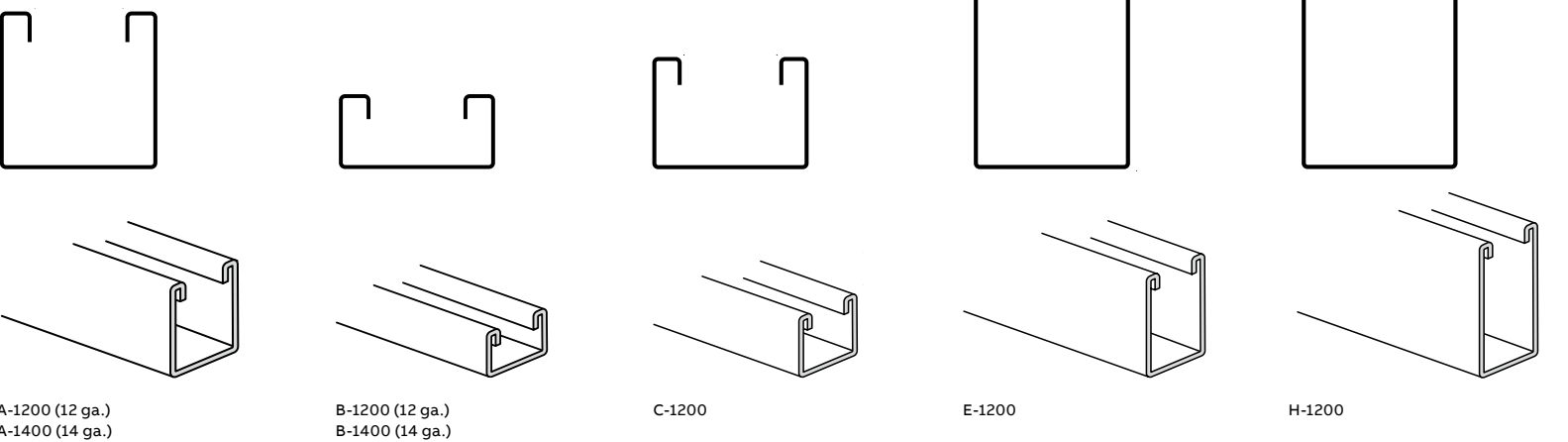

# Superstrut®

## Channel, slotted angle and concrete inserts

**Steel channels**  
GoldGalv® finish 1/8", continuous slot and 10" and 20" lengths.  
Also available in pre-galvanized, green, hot dipped, galvanized, stainless steel and PVC coated.



## Hole configurations

Half slot channel (HS)	
Cat. no.	Size (in.)
3/8" x 1 1/2" slot on 2" centers	
A-1200-HS	1 1/2 x 1 1/2
B-1200-HS	1 1/2 x 1 1/2
C-1200-HS	1 1/2 x 1 1/2
E-1200-HS	1 1/2 x 1 1/2
H-1200-HS	1 1/2 x 3/8
A-1400-HS	1 1/2 x 1 1/2
B-1400-HS	1 1/2 x 1 1/2

Slotted channel (S)	
Cat. no.	Size (in.)
3/8" x 3" slots on 4" centers	
A-1200-S	1 1/2 x 1 1/2
B-1200-S	1 1/2 x 1 1/2
A-1400-S	1 1/2 x 1 1/2
B-1400-S	1 1/2 x 1 1/2

Punched channel (P)	
Cat. no.	Size (in.)
3/8" holes on 1 1/2" centers	
A-1200-P	1 1/2 x 1 1/2
B-1200-P	1 1/2 x 1 1/2
H-1200-P	1 1/2 x 3/8
A-1400-P	1 1/2 x 1 1/2
B-1400-P	1 1/2 x 1 1/2

Channel with knockouts (KO)	
Cat. no.	Size (in.)
KO for 3/8" conduit	
A-1200-KO	1 1/2 x 1 1/2
A-1400-KO	1 1/2 x 1 1/2

## Stainless steel/special metals

Aluminum channel	
Cat. no.	Size (in.)
Available in 10" and 20" lengths	
A-1200-AL	1 1/2 x 1 1/2 x 13 gauge
A-1200-HS-AL	1 1/2 x 1 1/2 x 13 gauge
A-1200-AL	1 1/2 x 3/8 x 14 gauge
B-1200-AL	1 1/2 x 1 1/2 x 14 gauge
B-1202-AL	1 1/2 x 1 1/2 x 14 gauge

Stainless steel channel suffix SS or S56 — type 304 and type 316	
Cat. no.	Size (in.)
Available in 10" and 10" lengths	
A-1200-SS	1 1/2 x 1 1/2 x 13 gauge
A-1200-HS-SS	1 1/2 x 1 1/2 x 13 gauge

## Combination channel

- A series section (also available in B, E, H and C series sections.)
- For 1 1/2" channel
  - Solid base
  - Available in HS holes

A1202	A1202-A	A1202-B	A1202-C	A1203-A	A1203-B	A1203-C
-------	---------	---------	---------	---------	---------	---------

## Concrete inserts/slotted angle

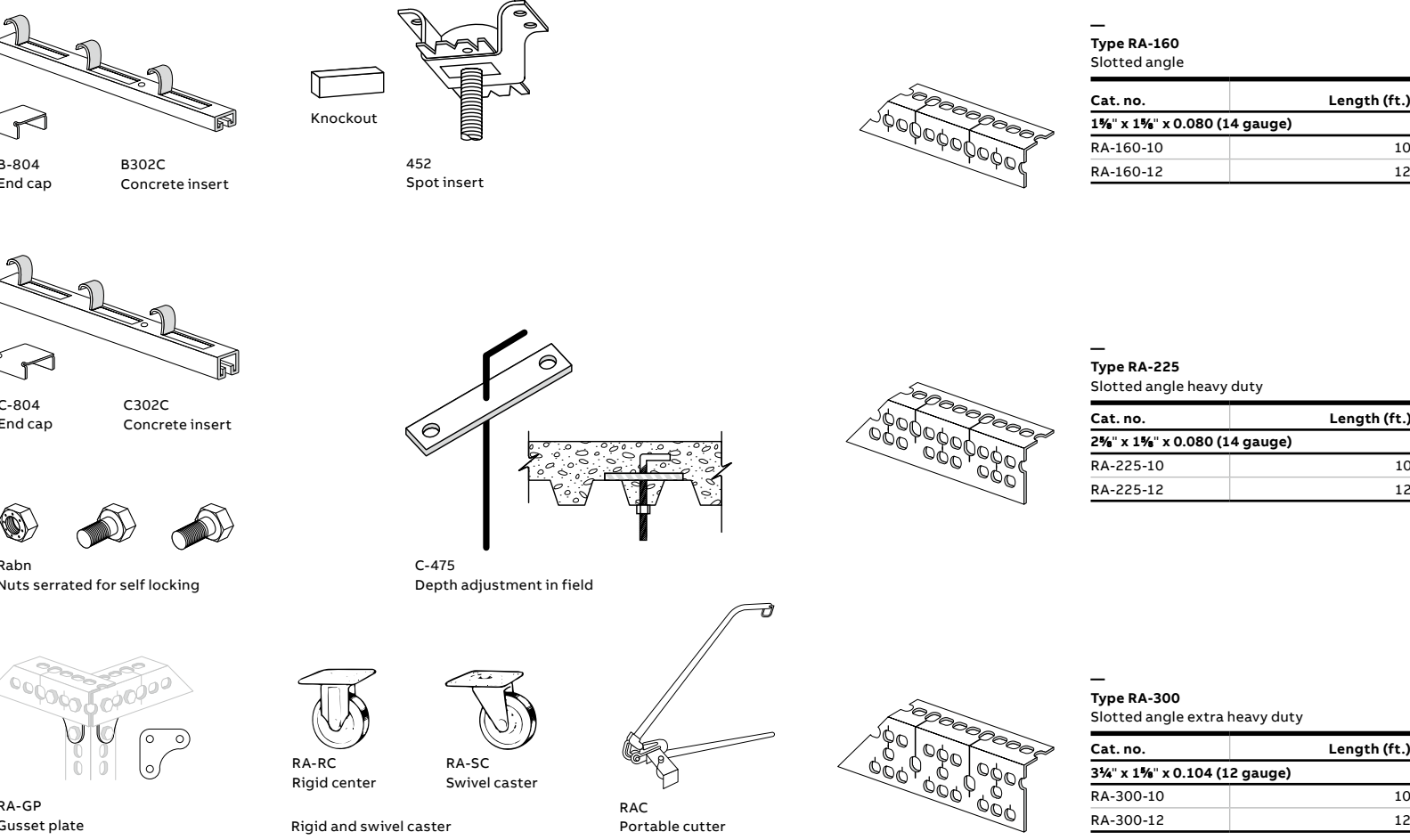

## Beam clamps and hanger supports

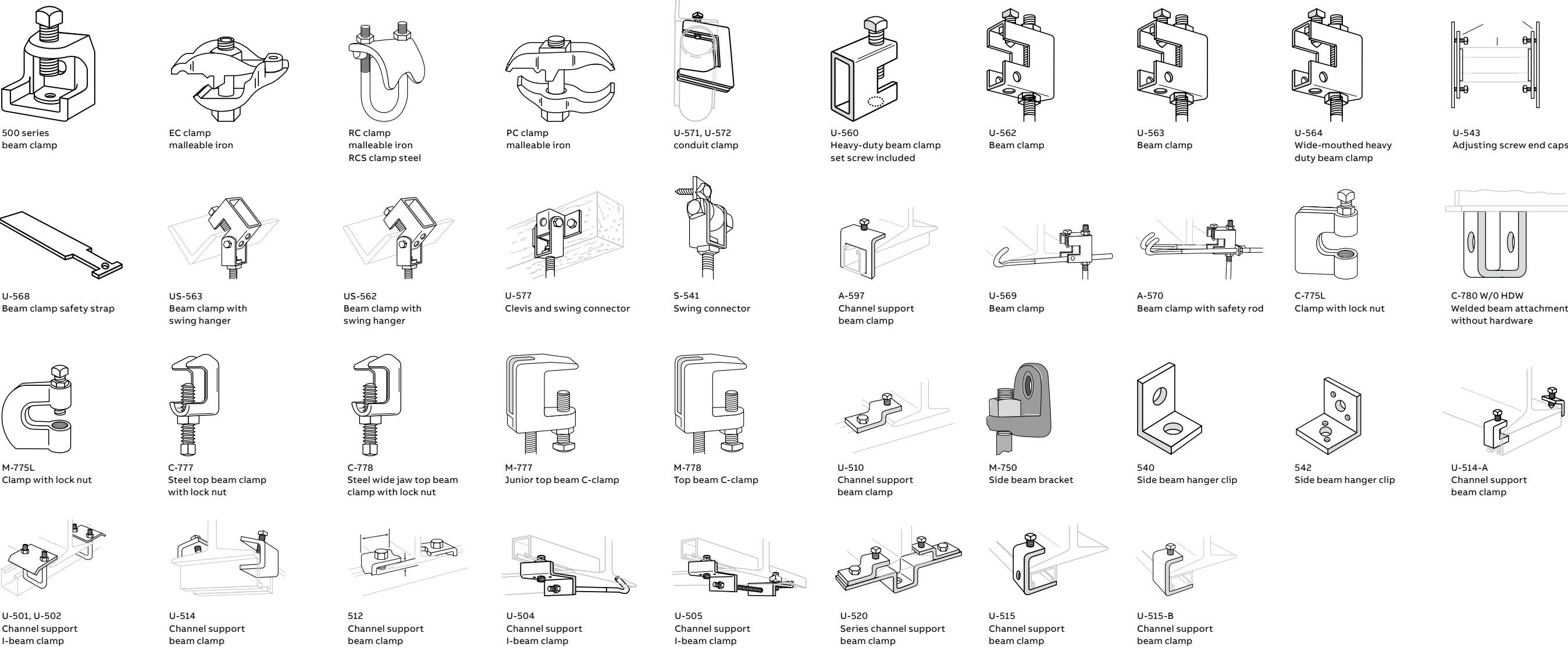

## Conduit and pipe hangers

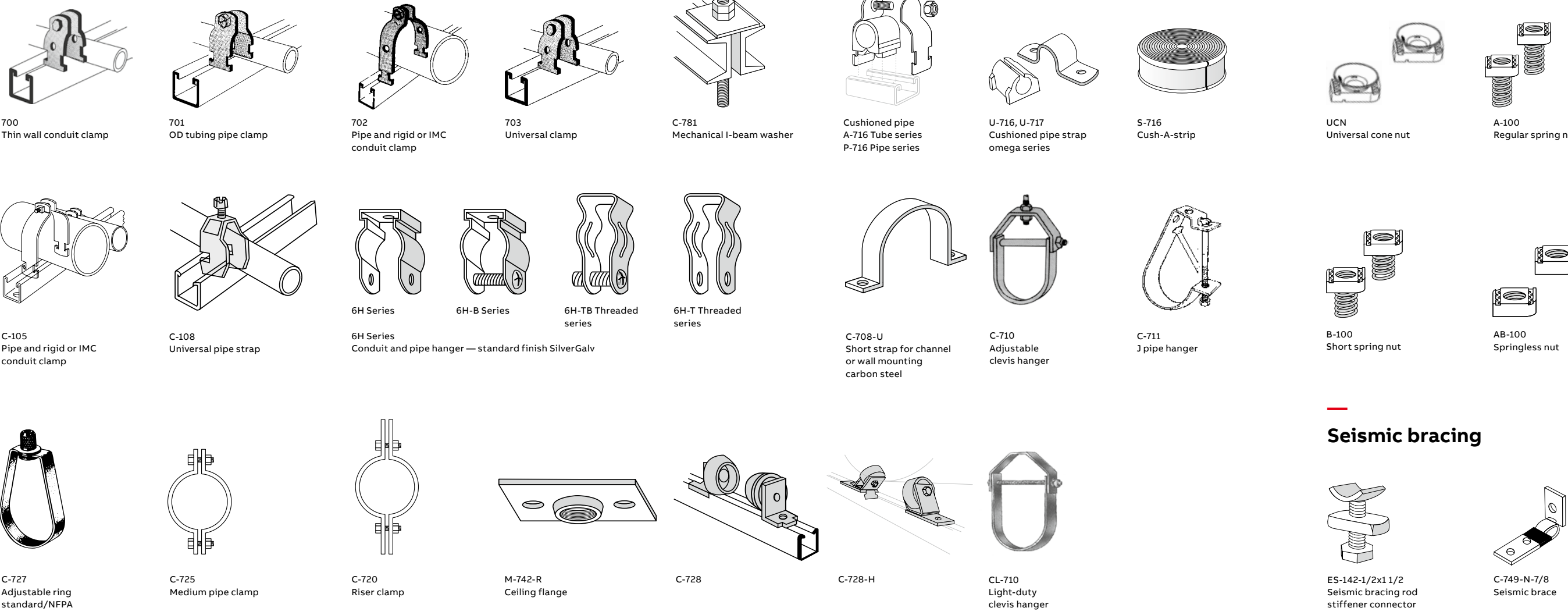

## Available finishes and materials

**GoldGalv®**  
The standard Superstrut GoldGalv finish involves a multi-step electrogalvanizing and zinc trivalent chromium process. The trivalent chromium finish is applied over the zinc, producing a chemically bonded non-porous barrier for protection from moisture and air. The 0.5 mil electro-plated zinc and gold trivalent chromium finish provides all of the features and protection of hexavalent chromium without the use of that chemical and is RoHS compliant.

**SilverGalv® (suffix EG)**  
The Superstrut SilverGalv finish is a post-fabrication, 12-step electrogalvanizing process that applies a clear conversion coat over 0.5 mils of zinc. This is identical to the process used in the GoldGalv finish without the gold-colored trivalent chromium conversion coat. The SilverGalv electrogalvanizing process provides a strong, cohesive molecular bond that locks out moisture and provides far superior corrosion resistance over standard G90 pregalvanized channel. The result is an abrasion-resistant protective finish that won't form white rust.

**Pregalvanized (suffix PG)**  
A zinc coating is applied by hot dipping the steel coil at the mill before fabrication. After the material is worked by roll-forming, cutting or punching, minimal protection is provided for raw edges. This weakness is typical with precoat material and affects the channel section around holes, extreme ends and the edges of the U-shaped lips. Superstrut pregalvanized material conforms to ASTM A-525/G-90, representing 0.9 oz. of zinc per square foot of steel. This finish is often referred to as hot-dipped mill galvanized or mill galvanized.

**Hot-dipped galvanized (suffix HDG)**  
The material is zinc coated after fabrication, providing total protection on all surfaces. The fabricated component is dipped into hot zinc for a prolonged period, creating a coherent bond for better corrosion resistance than pregalvanizing. Hot-dipped galvanizing is not recommended for threaded products, because the thickness of the zinc may disrupt the threads. Superstrut hot-dipped galvanized material conforms to ASTM A-123 and A-153, maintaining a minimum 1.5 oz. of zinc per square foot of steel or 2.5 mils. This finish is also referred to as hot-dipped galvanized after fabrication.

**Stainless steel — type 304 (suffix SS) and type 316 (suffix S56)**  
Superstrut channel and most accessories are available in type 304 stainless steel material. Channel and many accessories are also available in type 316 stainless steel for superior corrosion resistance.

**Other available finishes and materials**  
Superstrut channel and accessories are also available in the following finishes and materials: green or white urethane powder coated (suffix GR or WH), PVC coated (suffix PVC), copper plated (T inserted as second digit of catalog number), black (suffix B) and aluminum (suffix AL).

## Channel nuts

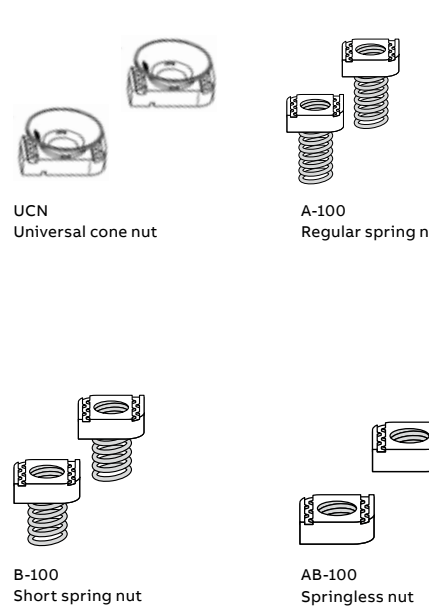

## Seismic bracing

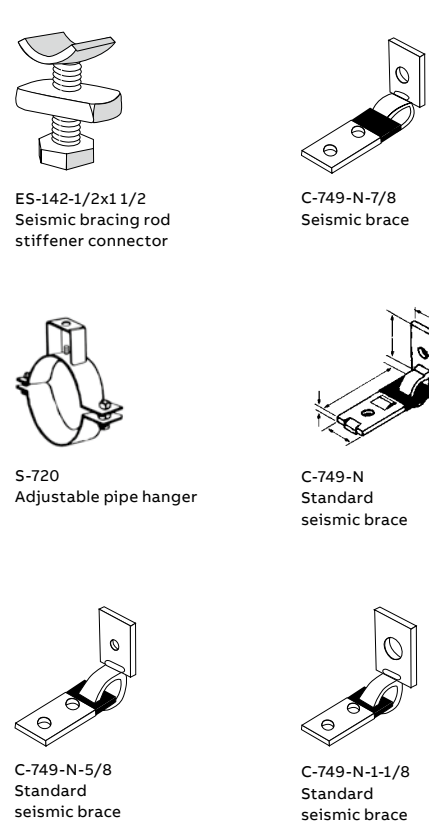

## Channel fittings

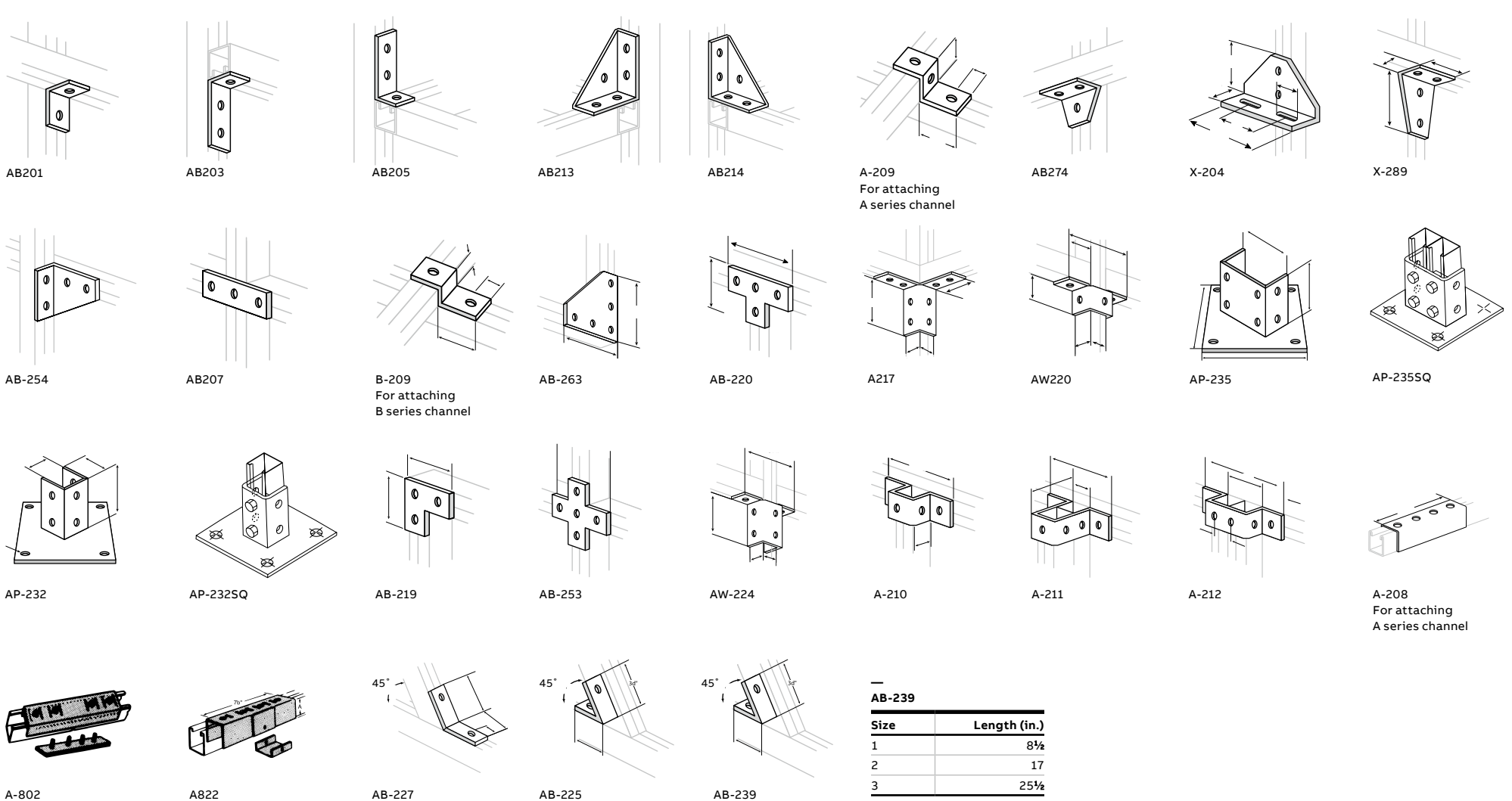

## Hardware and threaded rod

Threaded rod	
H-104 hanger rod Continuous thread. Standard Finish: GoldGalv	
Cat. no.	Thread size (in.)
H-104-1/4 x 6	1/4-20
H-104-1/4 x 10	1/4-20
H-104-1/4 x 12	1/4-20
H-104-3/8 x 6	3/8-16
H-104-3/8 x 10	3/8-16
H-104-3/8 x 12	3/8-16
H-104-1/2 x 6	1/2-13
H-104-1/2 x 10	1/2-13
H-104-1/2 x 12	1/2-13
H-104-5/8 x 6	5/8-11
H-104-5/8 x 10	5/8-11
H-104-5/8 x 12	5/8-11

Hanger rod load chart	
Rod size (in.)	Ultimate** loads in lbs.
1/4-20	900
3/8-16	1900
1/2-13	3500
5/8-11	6000

\*\*Safety Factor of 3.

H-119 Steel rod coupling	
Cat. no.	Rod size (in.)
H-119-1/4	1/4
H-119-3/8	3/8
H-119-1/2	1/2
H-119-5/8	5/8

E-142 hex head Cap screw (less nut)		
For connections of fittings to channels, use H-113-A for 1/4" deep channels and H-113-B for all other channels. GoldGalv finish.		
Cat. no.	Size (in.)	Weight (lbs./C)
E-142-1/4x1	1/4 x 1	1
E-142-1/4x1 1/4	1/4 x 1 1/4	2
E-142-1/4x1 1/2	1/4 x 1 1/2	2
E-142-1/4x2 1/4	1/4 x 2 1/4	3
E-142-3/8x3/4	3/8 x 3/4	3
E-142-3/8x1	3/8 x 1	4
E-142-3/8x1 1/4	3/8 x 1 1/4	4
E-142-3/8x1 1/2	3/8 x 1 1/2	5
E-142-3/8x2 1/4	3/8 x 2 1/4	7
E-142-1/2 x15/16	1/2 x 1 5/16	9
E-142-1/2x1 1/4	1/2 x 1 1/4	9
E-142-1/2x1 1/2	1/2 x 1 1/2	10
E-142-1/2x2	1/2 x 2	14
E-142-1/2x2 1/2	1/2 x 2 1/2	16

AB-241 square washer		
Cat. no.	Size (in.)	Thickness (in.)
AB-241-1/4	1/4	1/4
AB-241-5/16	5/16	5/16
AB-241-3/8	3/8	3/8
AB-241-1/2	1/2	1/2
AB-241-5/8	5/8	5/8
AB-241-3/4	3/4	3/4
AB-241-7/8	7/8	7/8

E-147 flat steel washer		
Cat. no.	Size (in.)	Weight (lbs./C)
E-147-1/4	1/4	0.67
E-147-5/16	5/16	1.20
E-147-3/8	3/8	2.00
E-147-1/2	1/2	3.85
E-147-5/8	5/8	7.70
E-147-3/4	3/4	9.00

E-148 lock washer		
Cat. no.	Size (in.)	Weight (lbs./C)
E-148-1/4	1/4	0.259
E-148-3/8	3/8	0.550
E-148-1/2	1/2	1.436
E-148-5/8	5/8	2.587
E-148-3/4	3/4	4.293

AB-242 saddle type washer		
For rigid attachment of rod to channel. For use with either 1/4" or 3/8" hanger rod.		

## Support brackets

