

INSTRUCTIONS

Msmart MV

Addendum w/MVC4-TCB



Table of contents

04	About Msmart
06–15	Msmart touch screen
16	Technical specifications
17	California Proposition 65 warning

About Msmart

General

Msmart consists of an active touch screen/information display. Msmart supports multiple languages and dedicated information and graphs for each product. Msmart also has a built-in an auto-sleep function with wake-up on motion.

Features

- Color touch panel
- Hardware pushbuttons for harsh environments
- Auto-sleep function with motion sensing
- Support for six (6) languages
- Virtual MVC4 keypad

Available information graphs

- Operation status
- Starting current graph
- Bar graph for RTD temperatures
- Three-phase voltage/current information
- Relay status

Dimensions

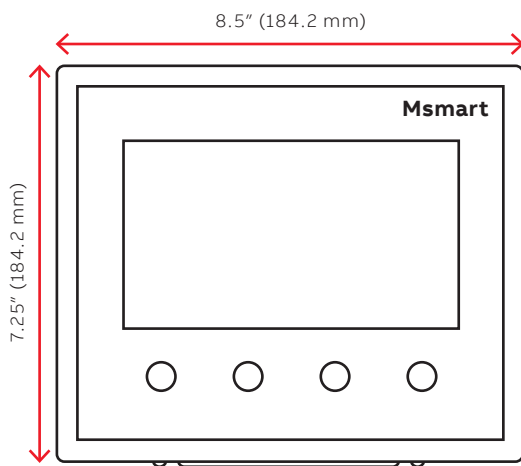

—
8.5" × 7.25" × 1.75" (H × W × D)
215.9 × 184.3 × 44.5 mm (H × W × D)

Msmart configuration

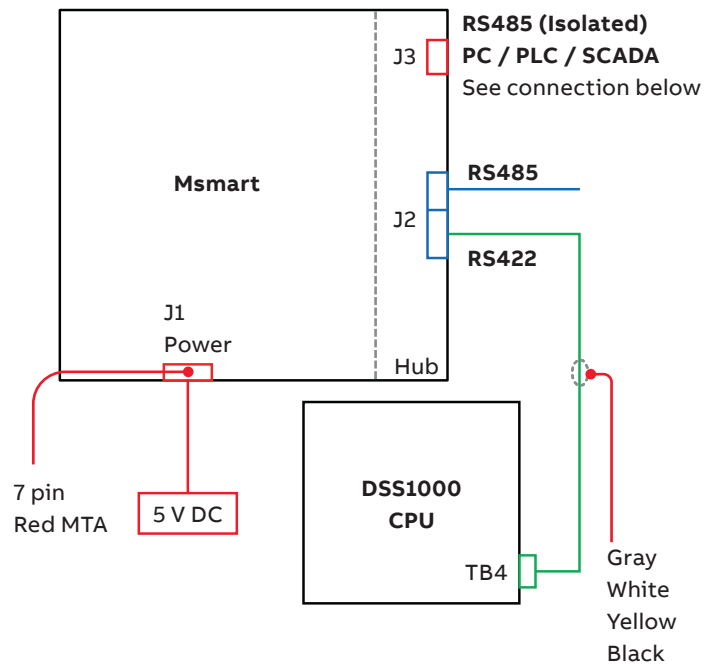

Msmart connection diagram to MVC4 medium voltage soft starter.

MVC4 MLink connection

Connect the RS485 converter to J3 of the Msmart touchscreen. Plug USB port into PC with MVC4 MLink software.

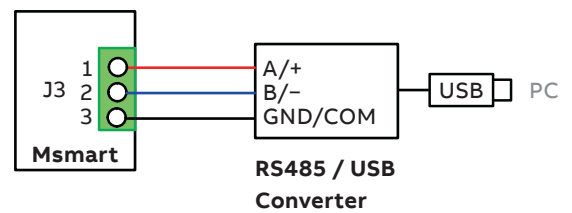

Msmart touch screen

Startup

After connecting the Msmart touch screen to the TCB, the system can be powered up.

Upon power-up, the Msmart will show a splash startup screen with a status bar indicating the Msmart startup status.

Next the Msmart touch screen will attempt to communicate with the MVC4 and additional devices. The online status is shown on the top of the screen. Green indicates device is communicating properly and red indicates communication cannot be established with the device.

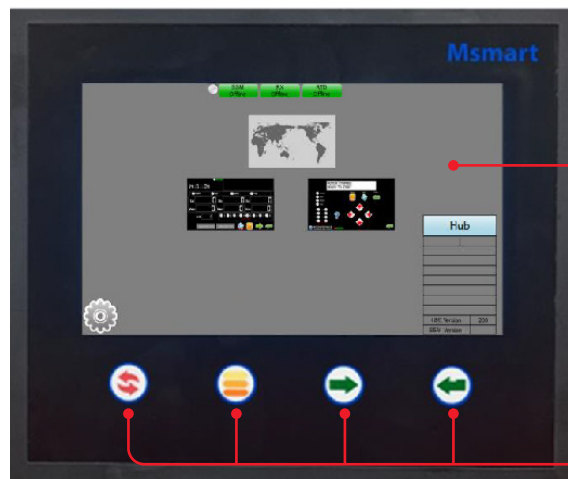

Touch screen

Panel buttons
Navigation buttons
(Button mode)

Msmart consists of a touch-screen and four membrane buttons for navigation that can be used when the system is installed in a harsh environment.



Resets the device on the screen only. Also resets the Msmart display by holding button for 6–10 sec.



Switch between touchscreen and panel buttons (button mode). Menu icon will flash when panel buttons are active.



Button used to move between selectable items on the touchscreen (forward Tab). The item will flash when selected.



Select flashing item.

Navigation and settings

Main menu

After powerup, Msmart will display the main menu navigation screen. The main menu allows the users to monitor and program all devices connected to the Msmart system.

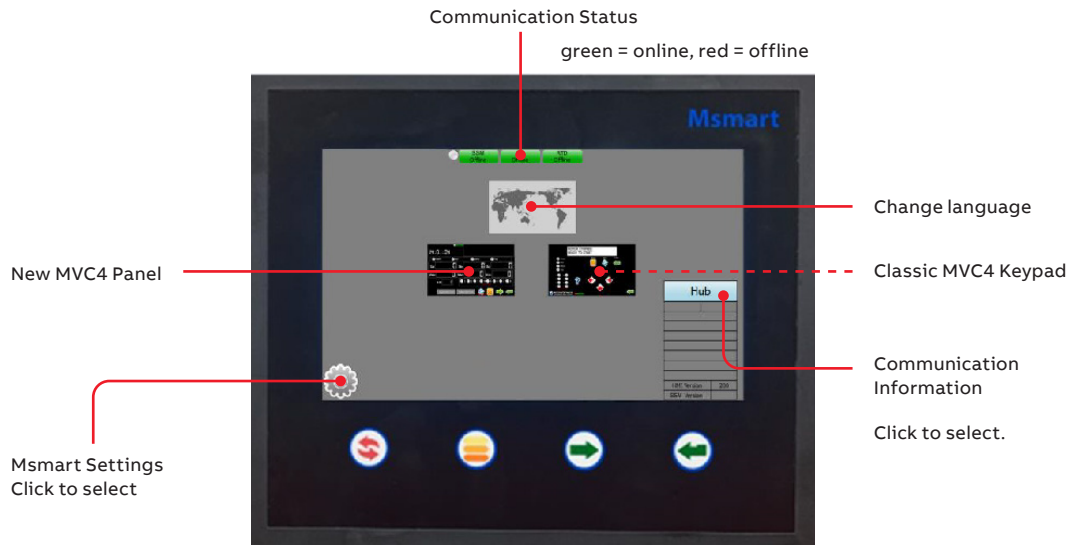

Communication status

The communication status indicators at the top of the screen indicate if the Msmart is communicating successfully with the connected devices. Green means communication is ok, red indicates communication has been lost.

Communication information

Click to display specific information about

- TCB communication connection
- RS232/RS422/RS485 communication

Main MVC4 status/Setup screen

The status screen shows current operation status and includes:

- Alarm and trip status
- Phase current and voltages
- Auxiliary relay status
- Starting curve for voltage and current
- MVC4 setpoint and metering page success

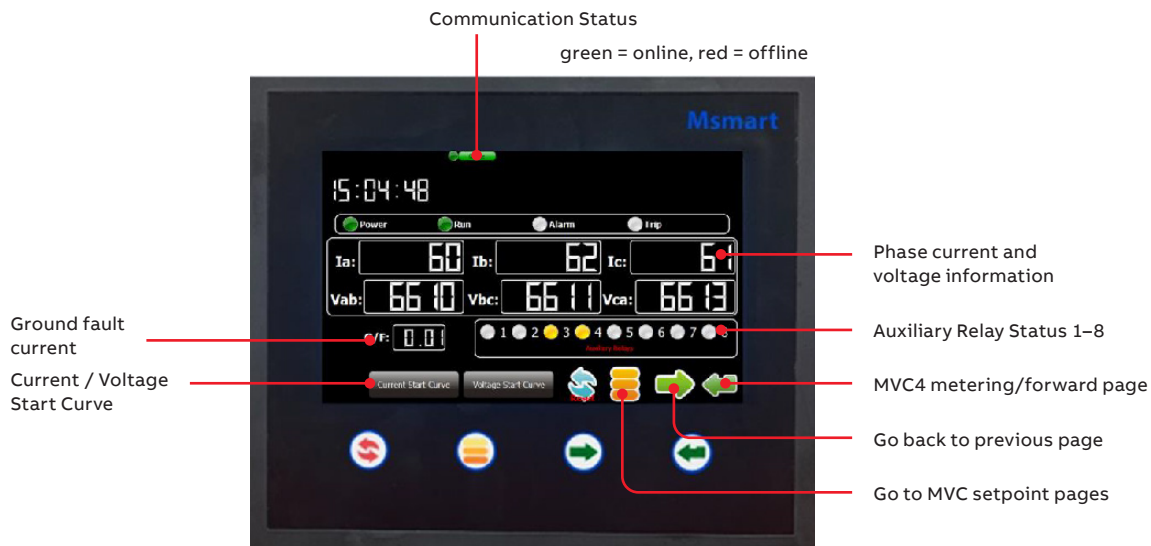

The MVC4 setpoint pages can be accessed by pressing the  button. See chapter **<MVNAME>** programming for more information.

The MVC4 metering pages can be accessed by pressing the  button. See chapter **<MVNAME>** metering for more information.

Msmart settings

Click on the gear tooth icon  to view/change the Msmart touch screen settings.

The following settings can be adjusted:

- Main page background color
- Backlight brightness
- Beep sound
- Save delay time
- Return delay to main menu



Device selection and programming

Device selection

Depending on the Msmart system configuration, all available devices will be displayed on the main menu page.

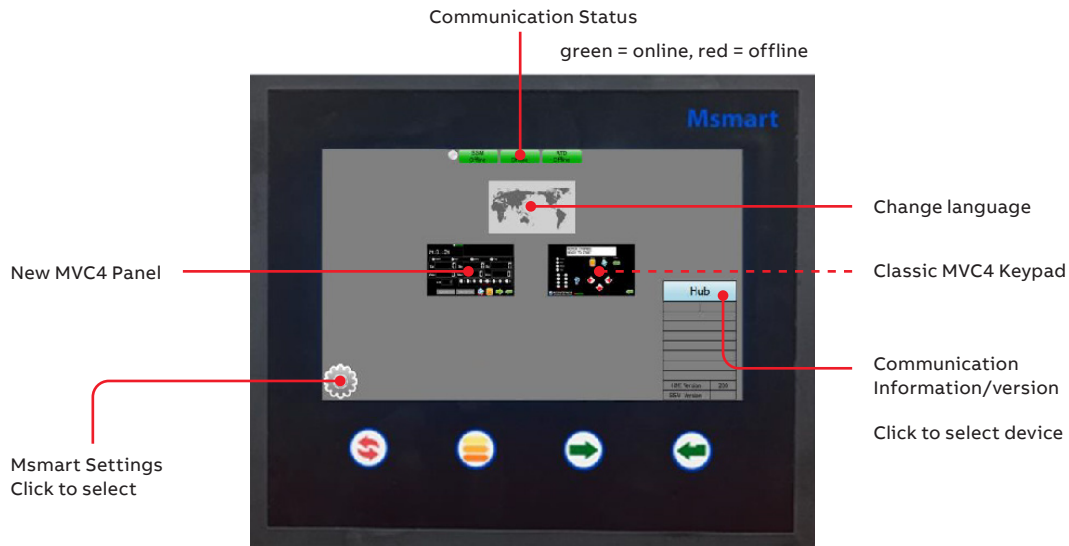

Navigation keys (Button mode)

Use touch screen or dedicated keys on the Msmart touch screen to select device.

MVC4 programming

The Msmart touch panel offers the user two ways to program the MVC4 soft starter:

1. Direct setpoint pages
2. Virtual MVC4 keypad

#1: Access MVC4 setpoint pages direct

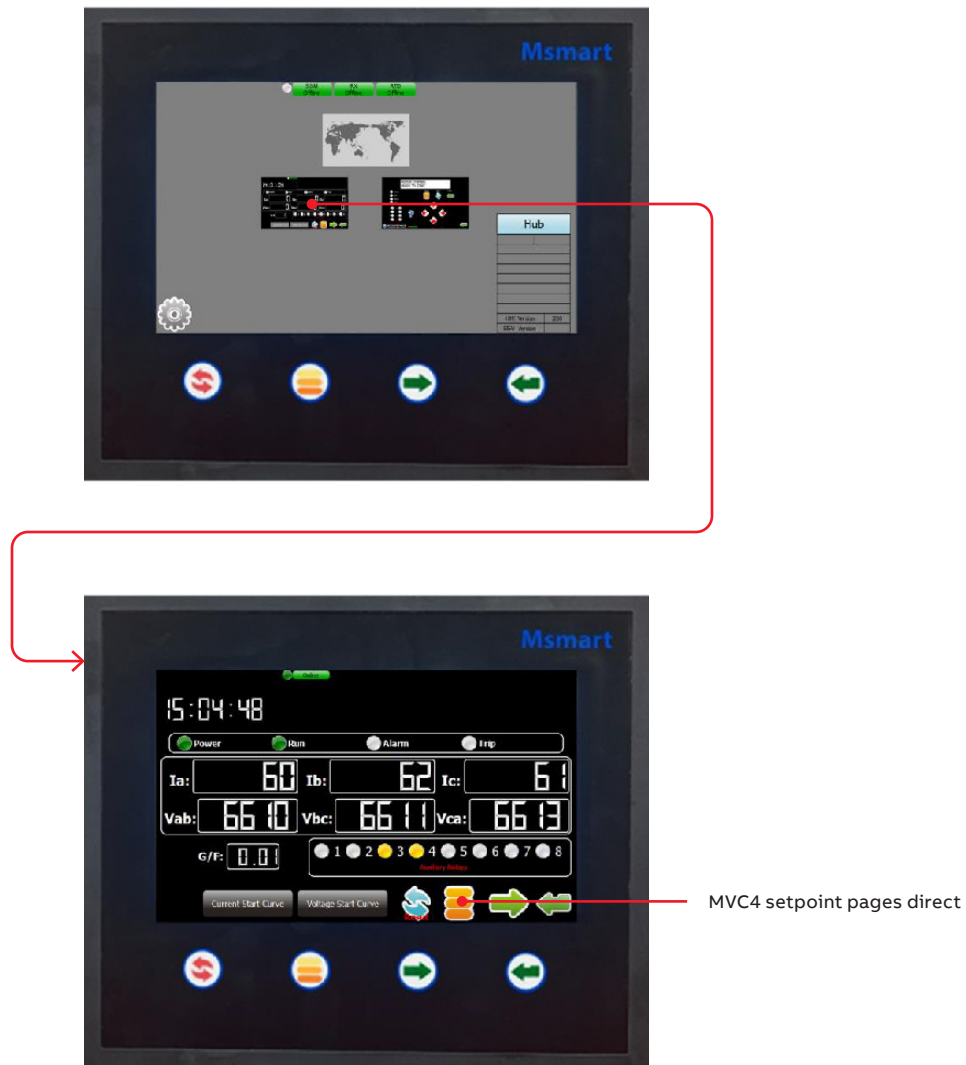

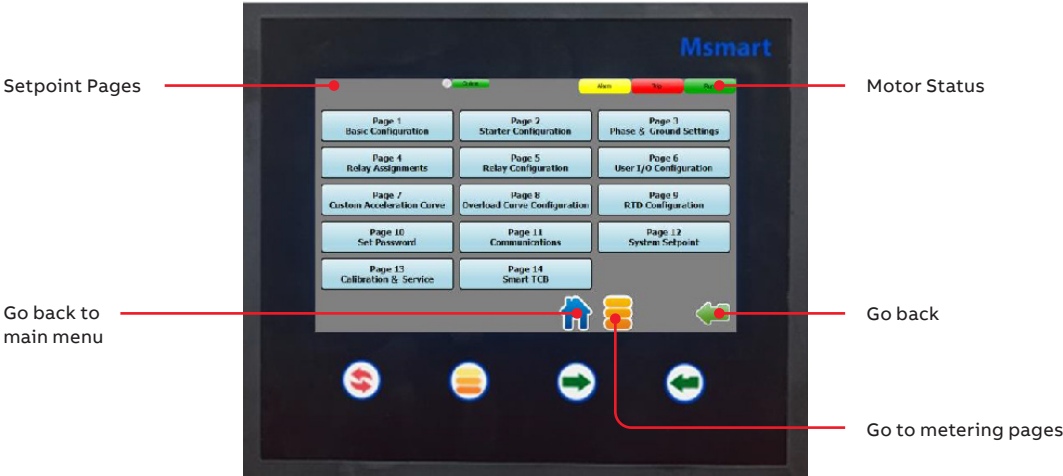

#1 Select setpoint page to view parameters direct

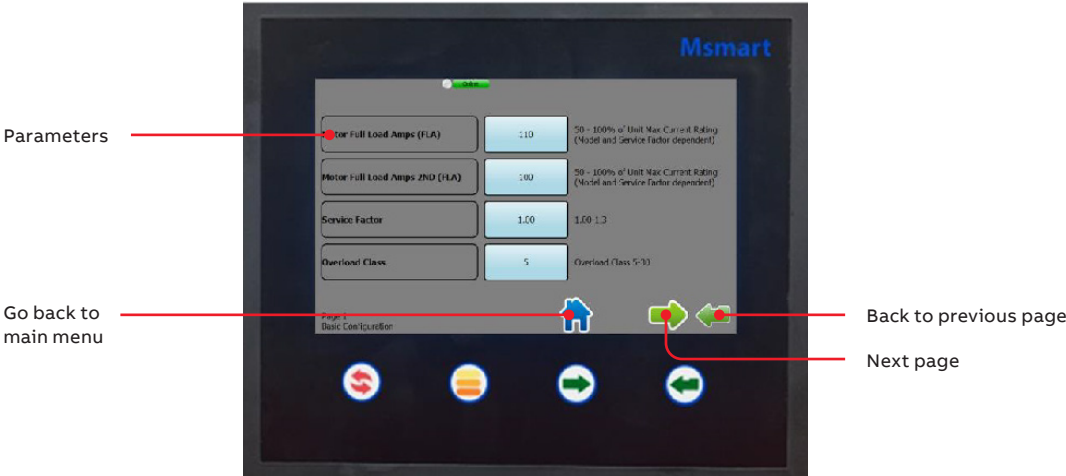

Change parameter settings

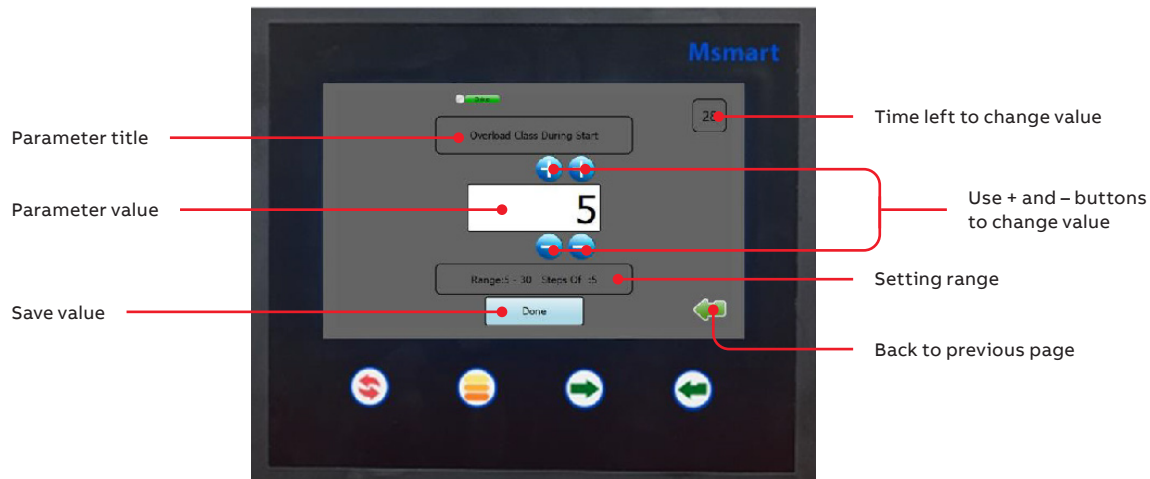

Click "done" button to save value

#2: Using the MVC4 virtual keypad

Click on the Classic MVC4 keypad in the Msmart main menu.

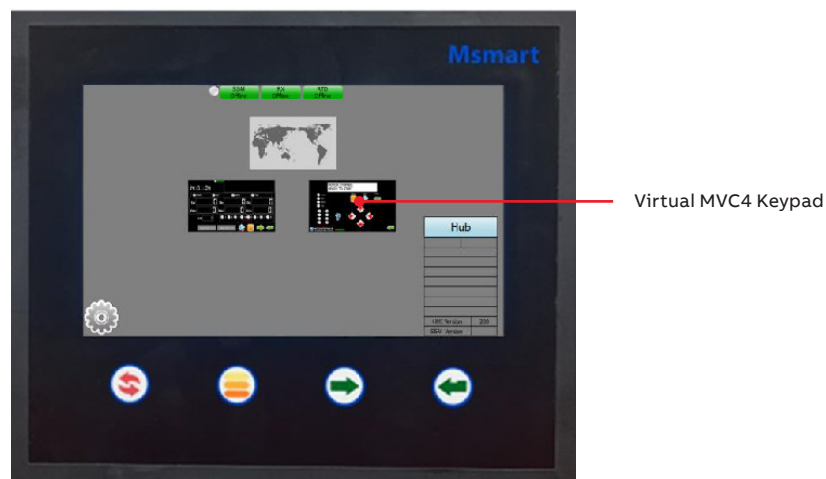

#2 Virtual MVC4 keypad

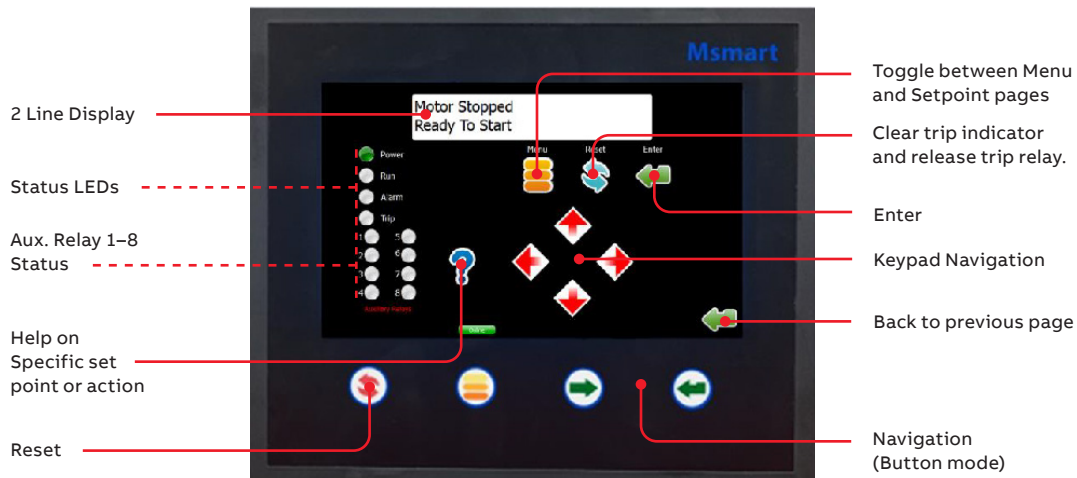

#2 Virtual keypad/Operator interface

The virtual keypad/operator interface consists of:

- 2 rows of 20 characters
- 12 indicator LEDs
- 8 buttons

NOTE: THE SOFT STARTER IS MENU DRIVEN AND THERE ARE THREE LEVELS OF PROGRAMMING. THE PROGRAMMING FOR TWO OF THESE LEVELS IS PASSWORD PROTECTED. LEVEL TWO REQUIRES A THREE-DIGIT PASSWORD AND LEVEL THREE REQUIRES A FOUR-DIGIT PASSWORD.

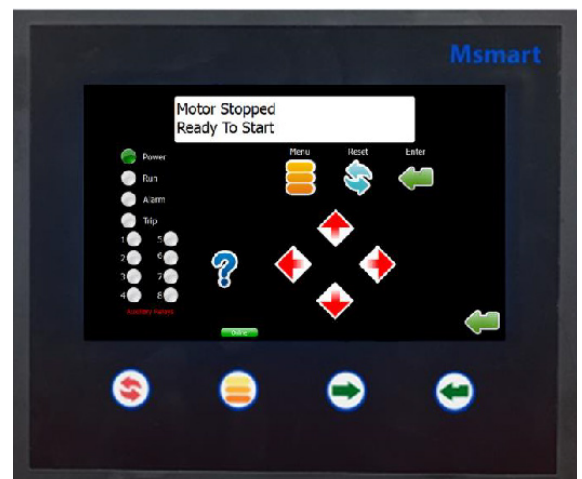

Item	Designation	Description
Key	MENU	Toggle between the menu selection for metering and set point pages.
	RESET	Will clear the trip indicator and release the trip relay.
	ENTER	Pressing the ENTER button once enters the EDIT mode where set point values can be changed. An "Asterisk" will appear on the display to indicate it is in the edit mode. After a set point value is changed, pressing the ENTER button again will save the revised value to memory and the asterisk will go off indicating the change has been saved. When not in the edit mode, the ENTER pushbutton will toggle through the event indicator list (such as alarms or trips).
	HELP	Provides general help information about a specific set point or action.
	UP ARROW	Will scroll up through the set point and metering menu page. It will scroll to the top of the set point page or a section. In edit mode it will increase a set point in an incremental step or toggle through the available options in the set point.
	RIGHT ARROW	In the main menu the RIGHT ARROW button provides access to the set point page. For set point pages with multiple columns, the RIGHT ARROW will scroll the set point page to the right. When in edit mode it will shift one character to the right.
	DOWN ARROW	Will scroll down through the set point pages and down through the set points. In edit mode, it will decrement through values and toggle available options in the set point.
	LEFT ARROW	Will move to the left through set point pages with multiple columns. When in edit mode it will become the backspace key and will shift one character to the left.
Led	POWER	Indicates control power is present.
	RUN	Indicates unit/motor is running.
	ALARM	Lights in conjunction with Relay AUX 2 to indicate an Alarm event or warn of possible critical condition.
	TRIP	Lights in conjunction with Relay AUX 1 to indicate a Trip condition has occurred.
	AUX 1–8	Auxiliary relays (Note: Relays 5–8 are available for customer use).

Technical specifications

Screen Type:	Resistive touch screen
Keypad:	4 membrane keys
Input Voltage:	5 VDC
Average Power Consumption:	3 W
Real-time Clock:	Standard
Operating Design Temperature:	32°F to 122°F / 0°C to 50°C
Storage Temperature:	-4°F to 176°F / -20°C to 80°C
Ambient Conditions:	5% to 95% relative humidity 0 to 3.300 ft (1.000 m) elevation
Approval:	UR (Recognized component)

California Proposition 65 warning

California customers:

California Proposition 65 Warning

WARNING: this product and associated accessories may contain chemicals known to the State of California to cause cancer, birth defects, or other reproductive harm.

For more information visit:
<https://p65warnings.ca.gov>



ABB Inc.

305 Gregson Drive
Cary, NC 27511 USA
abb.com/contacts

abb.com/mediumvoltage

The information contained in this document is for general information purposes only. While ABB strives to keep the information up to date and correct, it makes no representations or warranties of any kind, express or implied, about the completeness, accuracy, reliability, suitability or availability with respect to the information, products, services, or related graphics contained in the document for any purpose. Any reliance placed on such information is therefore strictly at your own risk. ABB reserves the right to discontinue any product or service at any time.

© Copyright 2022 ABB. All rights reserved.