

We reserve all rights in this document and in the information contained herein. Reproduction, use or disclosure to third parties without express authority is strictly forbidden. © Copyright 2003 ABB

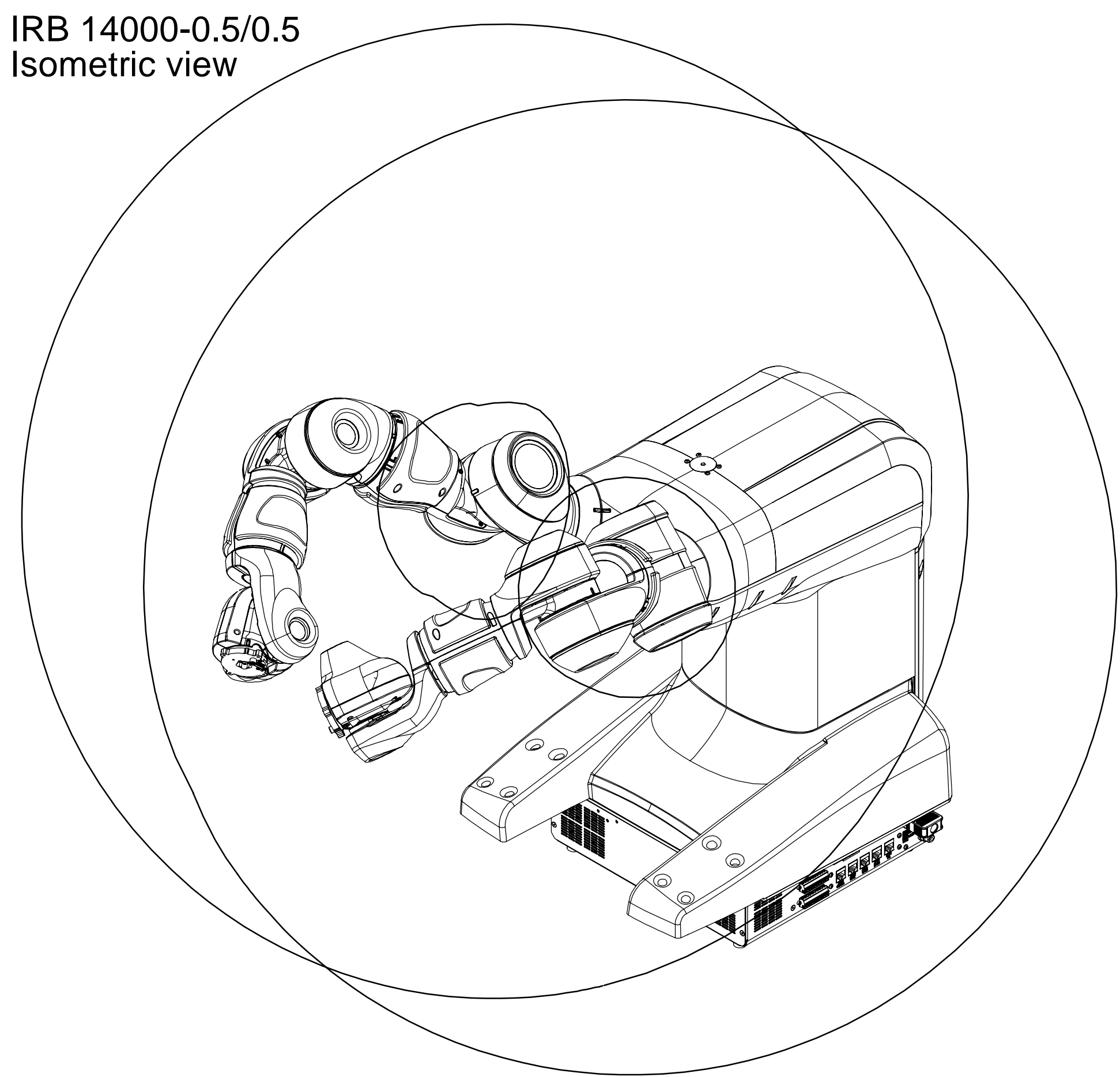
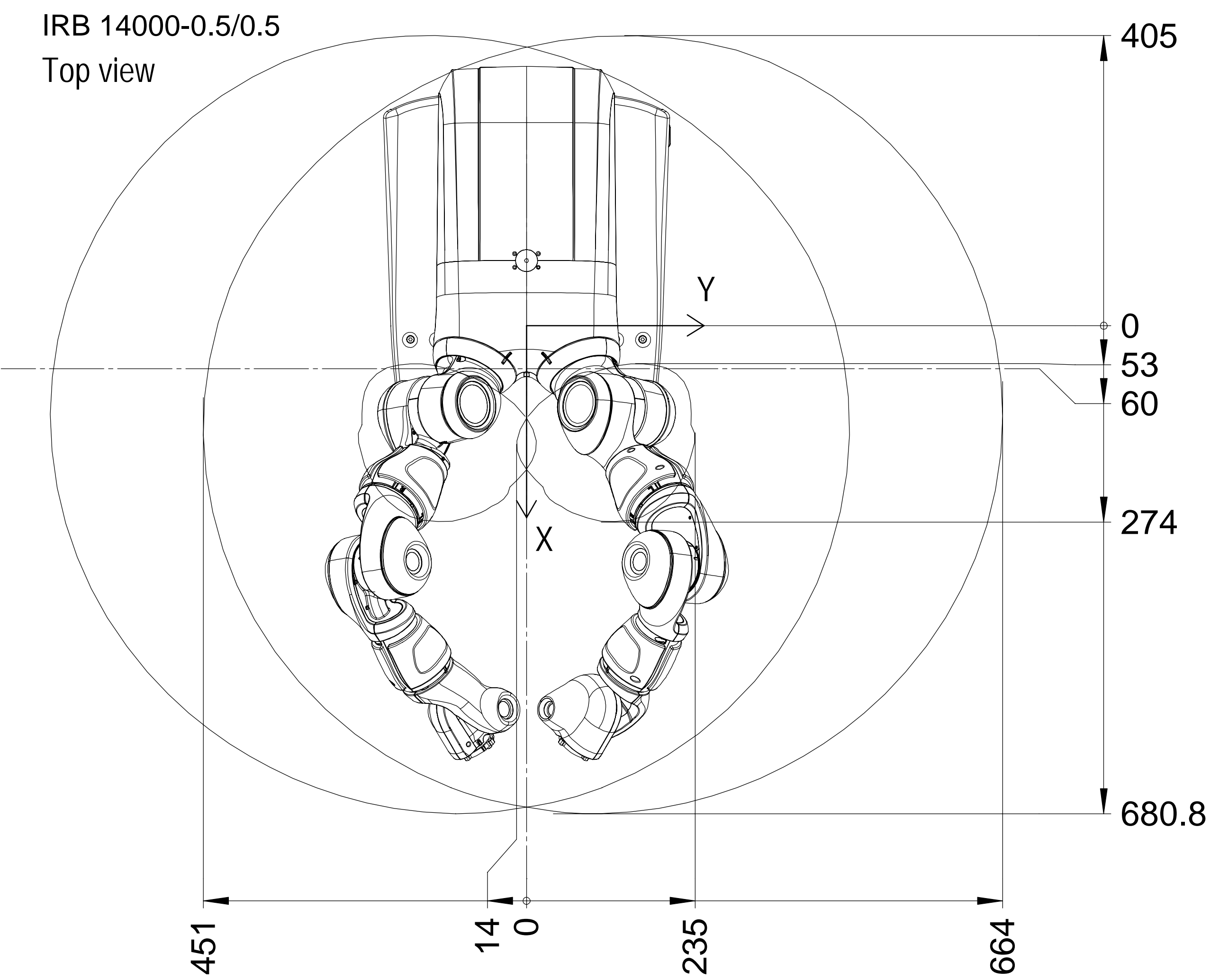
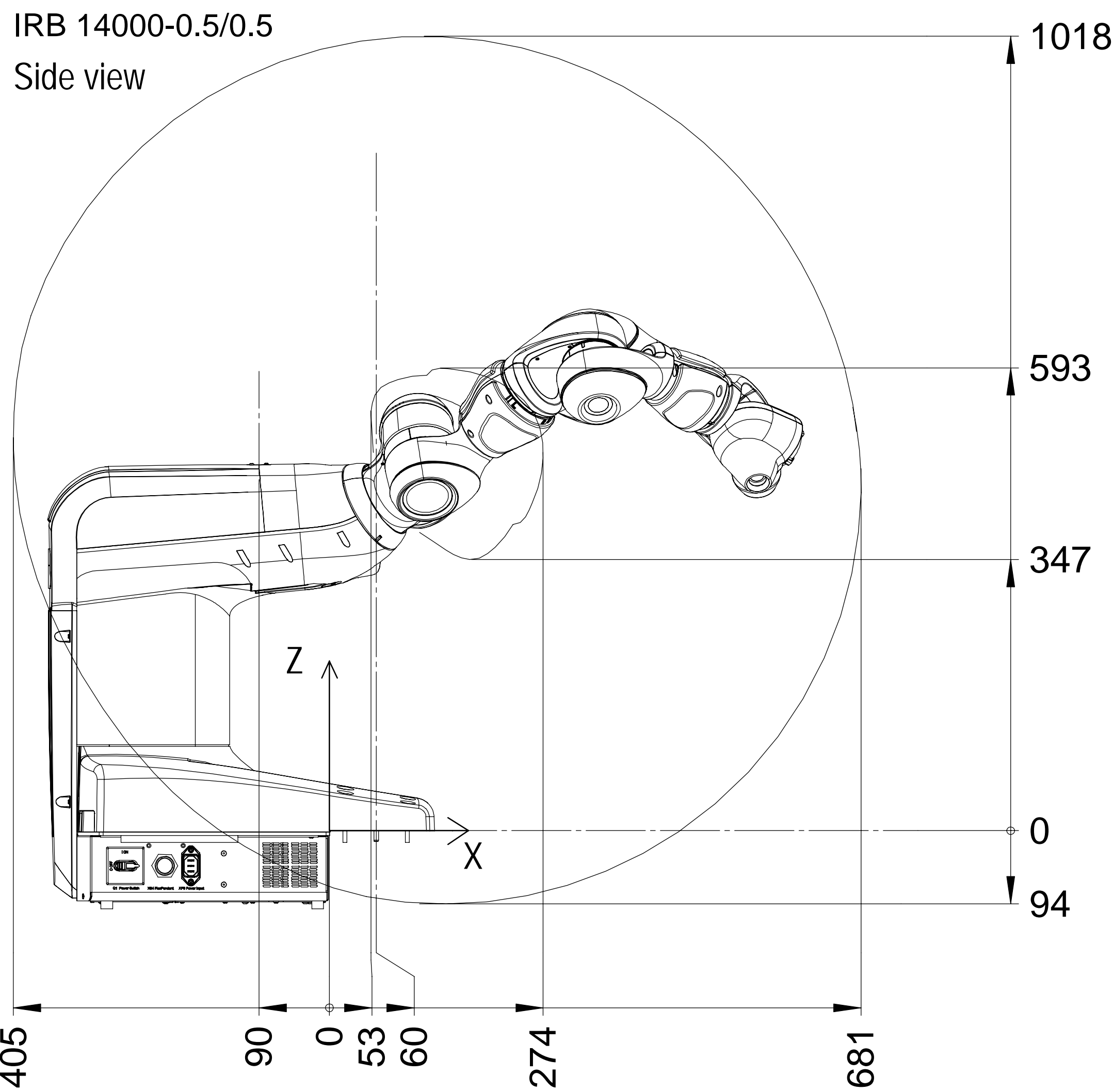
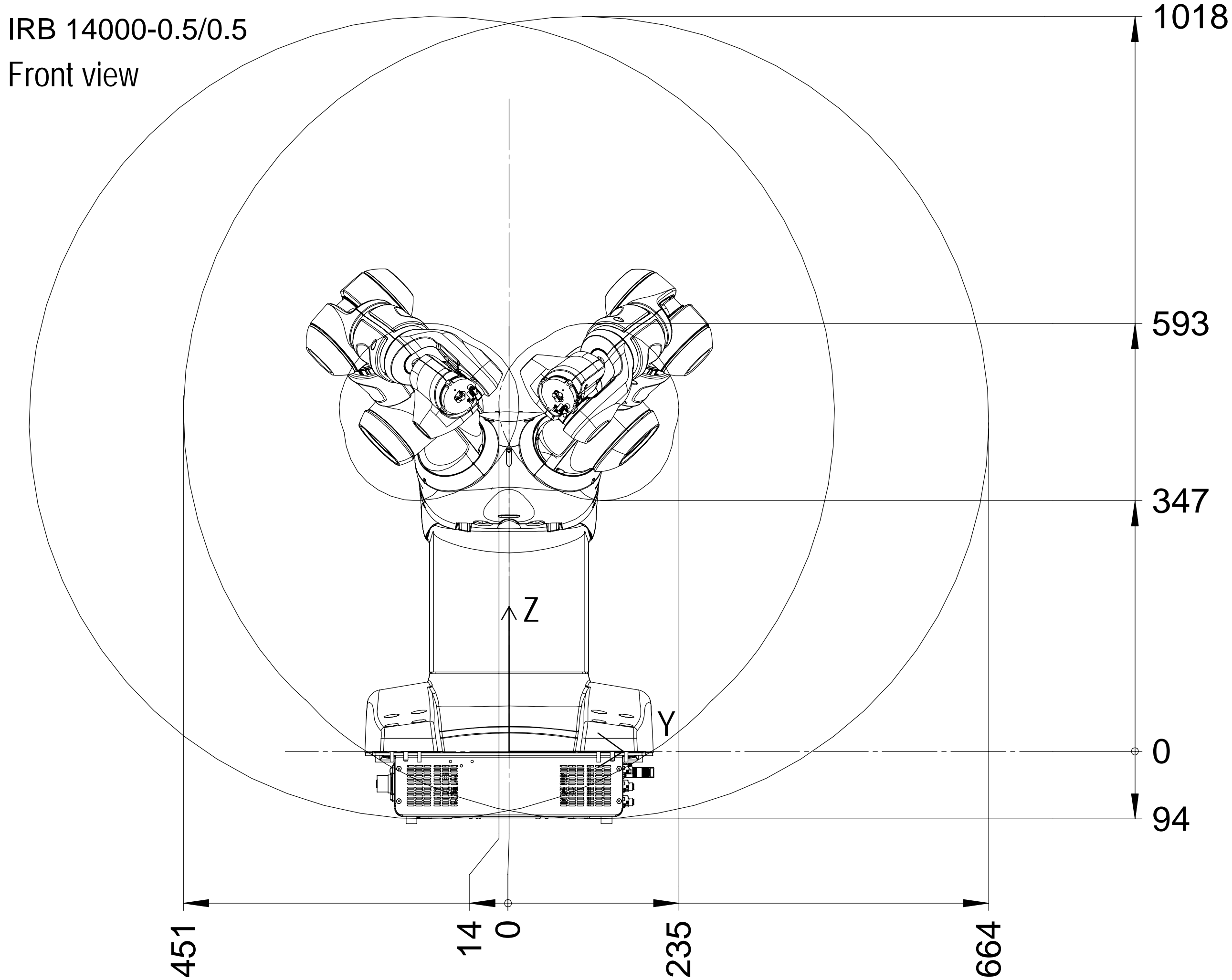

New

Latest Revision

Prepared

G Ma, 150428

Approved

K Wang, 150522

Status

Approved

ABB

Responsible Department

DMRO CN/RM

Take over department

ECO number

500000068043

Description

Working area IRB 14000

Document no.

3HAC050778-006

SWD

Drawing

Sheet

1

No. of sh.

2

Rev. ind.

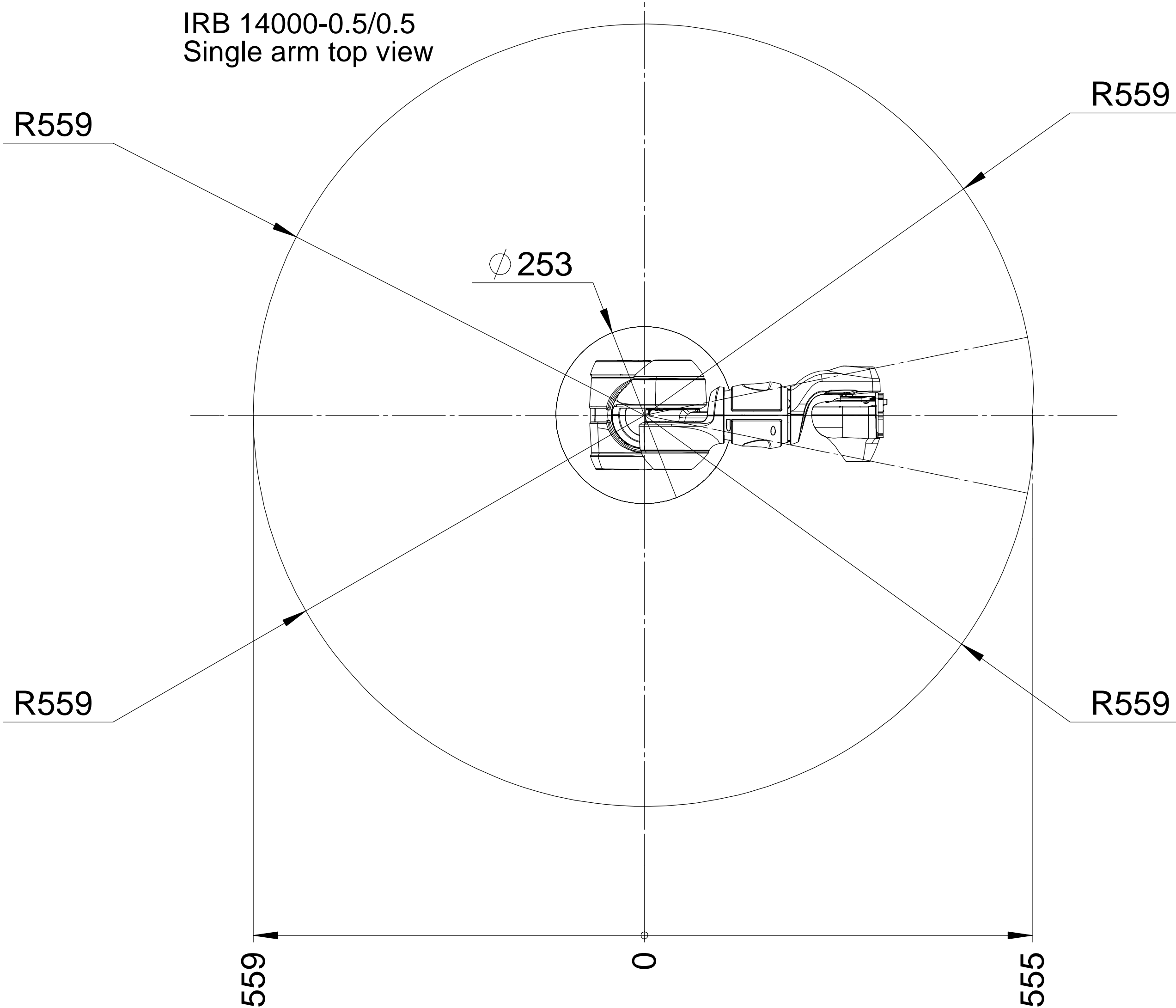
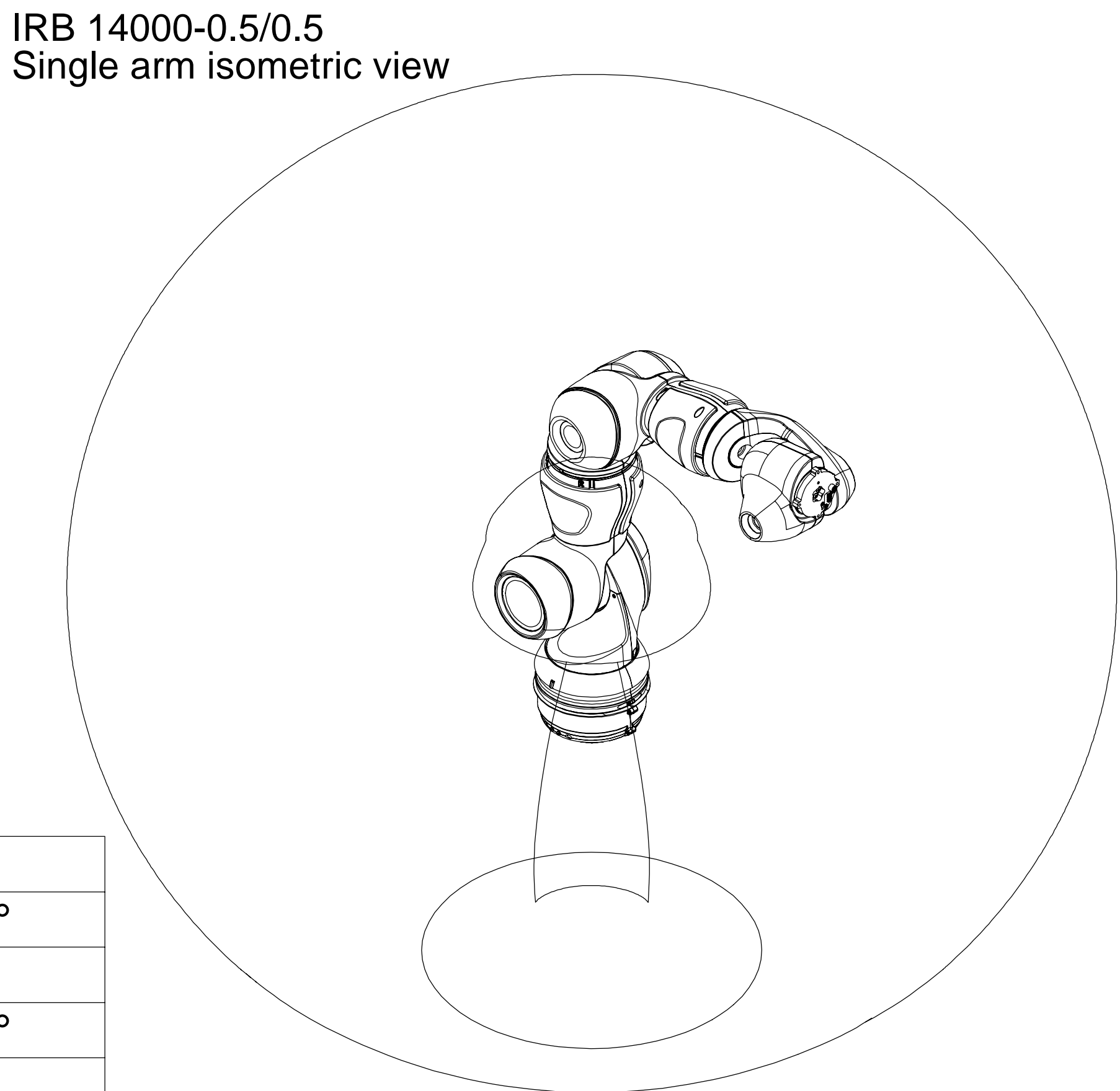
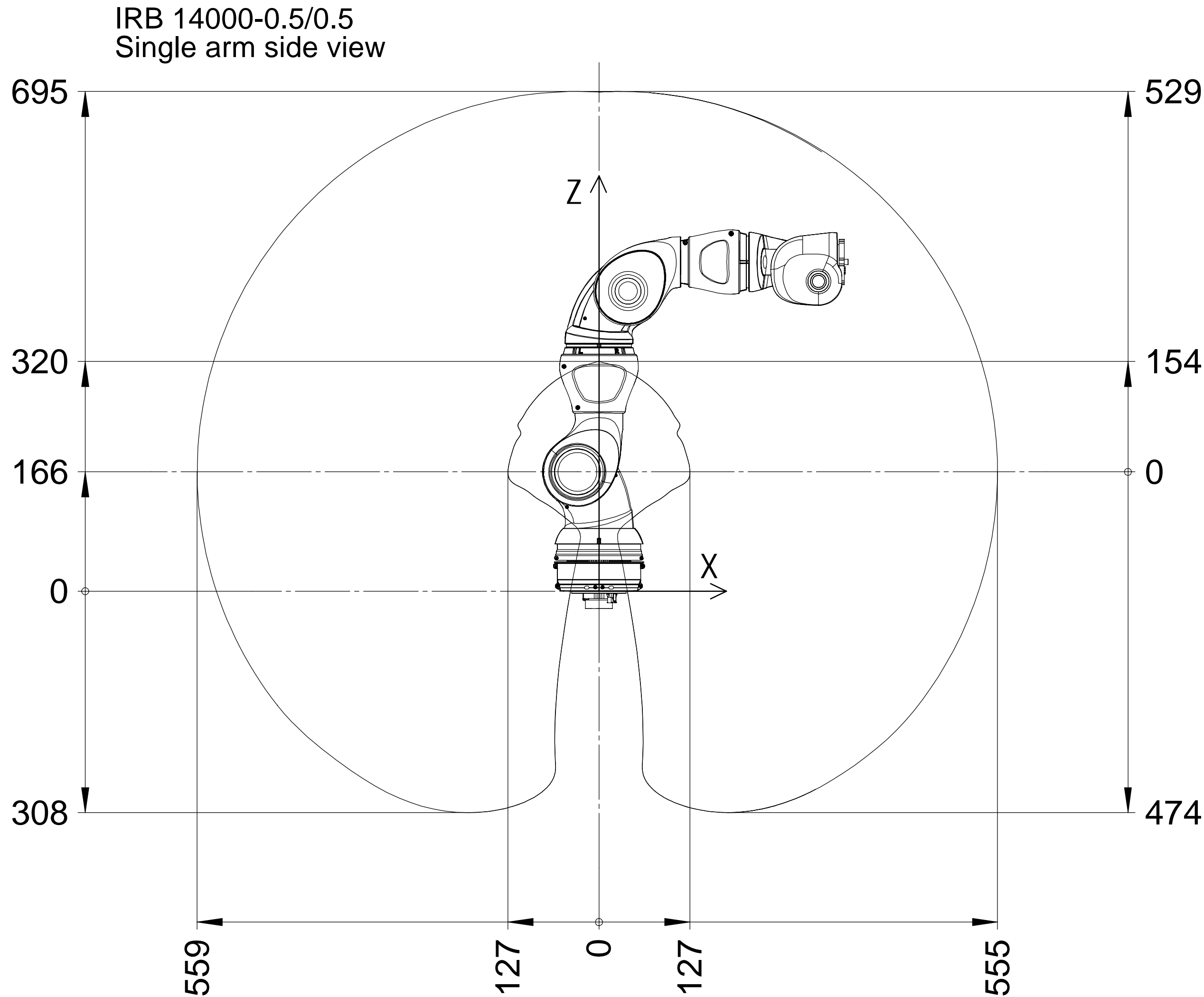
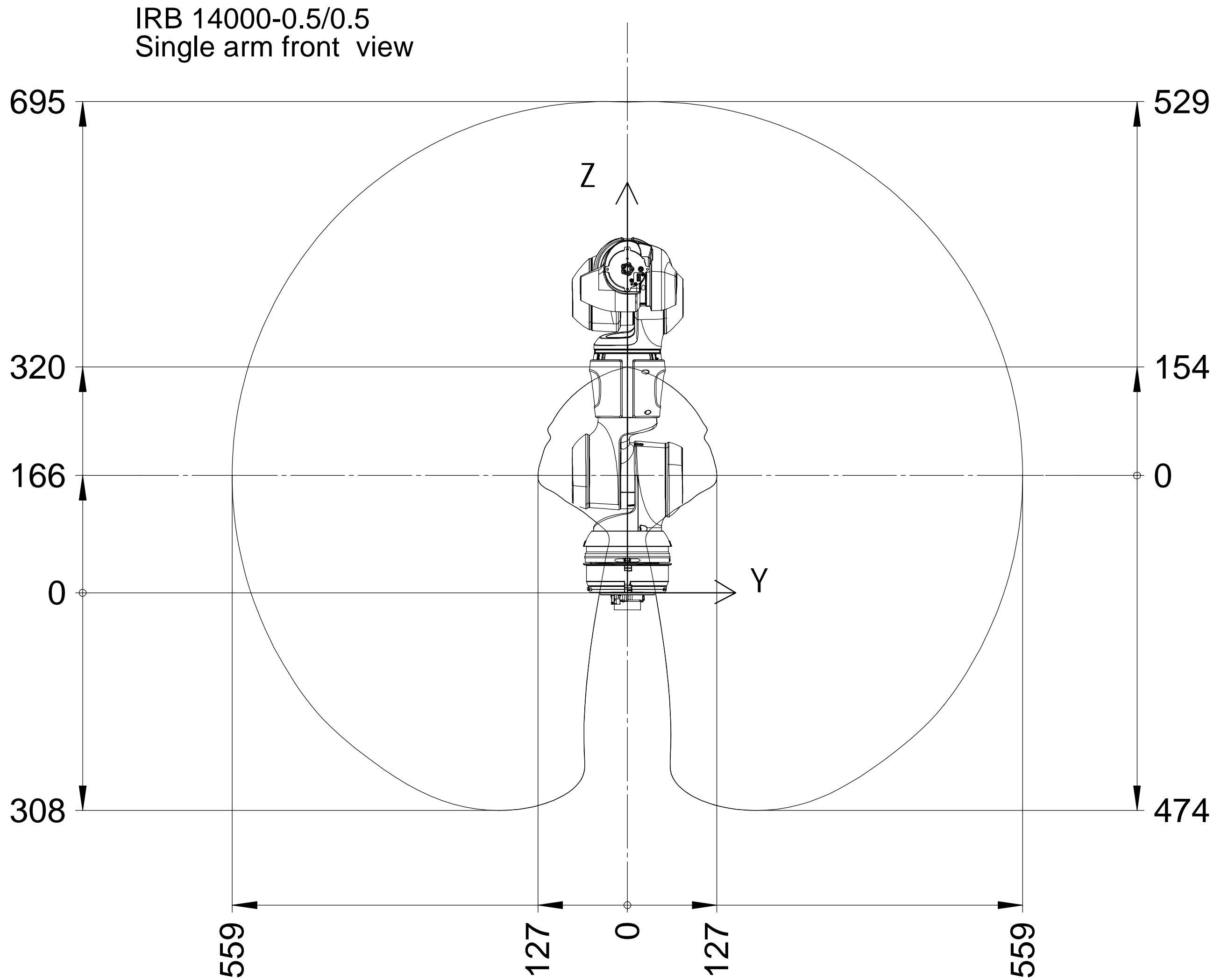

IRB 14000-0.5/0.5

Working range		
Ax.1	-168.5°	+168.5°
Ax.2	-143.5°	+43.5°
Ax.7	-168.5°	+168.5°
Ax.3	-123.5°	+80°
Ax.4	-290°	+290°
Ax.5	-88°	+138°
Ax.6	-229°	+229°

IRB 14000

Pos	Position at wrist center (mm)		Angle (degrees)			
	X	Z	Axis 1	Axis 2	Axis 7	Axis 3
1	-559.2	166	0	-105.7	0	-65.7
2	0	694.5	Any angle	-12.4	0	-65.7

Prepared G Ma, 150428	Responsible Department DMRO CN/RM	Description Working area IRB 14000	SWD	Drawing	
Approved K Wang, 150522	Take over department				
Status Approved	ECO number 500000068043				
Latest Revision		Document no. 3HAC050778-006			