



INSTALLATION GUIDE

PANIC EXIT DEVICE

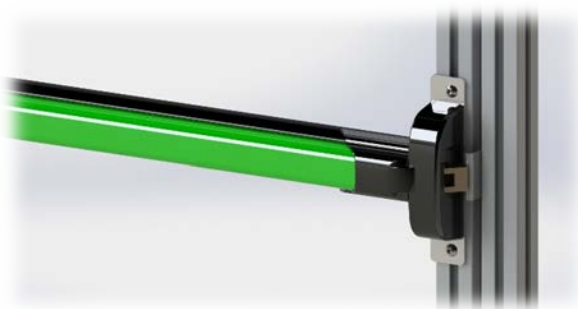

Table of Contents

Read and understand this document	2
WARRANTY	2
LIMITATIONS OF LIABILITY	2
SUITABILITY FOR USE.....	2
PERFORMANCE DATA.....	2
OVERVIEW	3
Panic Exit Device	4
Lever Handle	4
Mounting kit	5
INSTALLATION	6
Drill hole.....	6
Mount support brackets.....	7
Panic Exit Device.	9
Lever handle	11
Strike plate.....	13
Details – Exploded view	14
Maintenance.....	15
Technical data	15

All given dimensions are in mm unless otherwise stated

We reserve the right to make technical changes or modify the contents of this document prior notice. With regard to purchase orders, the agreed particulars shall prevail. ABB AB, Jokab Safety does not accept any responsibility whatsoever for potential errors or possible lack of information in this document.

We reserve all rights in this document and in the subject matter and illustrations contained therein. Any reproduction, disclosure to third parties or utilization of its contents – whole or in parts – is forbidden without prior written consent of ABB AB, Jokab Safety

Copyright © 2015 ABB

All rights reserved

Read and understand this document

Please read and understand this document before using the products. Please consult your ABB/JOKAB SAFETY representative if you have any questions or comments.

WARRANTY

ABB/JOKAB SAFETY's exclusive warranty is that the products are free from defects in materials and workmanship for a period of one year (or other period if specified) from date of sale by ABB/JOKAB SAFETY. ABB/JOKAB SAFETY MAKES NO WARRANTY OR REPRESENTATION, EXPRESSED OR IMPLIED, REGARDING NON-INFRINGEMENT, MERCHANTABILITY, OR FITNESS FOR PARTICULAR PURPOSE OF THE PRODUCTS, ANY BUYER OR USER ACKNOWLEDGES THAT THE BUYER OR USER ALONE HAS DETERMINED THAT THE PRODUCTS WILL SUITABLY MEET THE REQUIREMENTS OR THEIR INTENDED USE. ABB/JOKAB SAFETY DISCLAIMS ALL OTHER WARRANTIES, EXPRESSED OR IMPLIED.

LIMITATIONS OF LIABILITY

ABB/JOKAB SAFETY SHALL NOT BE RESPONSIBLE FOR SPECIAL, INDIRECT, OR CONSEQUENTIAL DAMAGES, LOSS OF PROFITS OR COMMERCIAL LOSS IN ANY WAY CONNECTED WITH THE PRODUCTS, WHETHER SUCH CLAIM IS BASED ON CONTRACT, WARRANTY, NEGLIGENCE, OR STRICT LIABILITY.

In no event shall responsibility of ABB/JOKAB SAFETY for any act exceed the individual price of the product on which liability asserted.

IN NO EVENT SHALL ABB/JOKAB SAFETY BE RESPONSIBLE FOR WARRANTY, REPAIR, OR OTHER CLAIMS REGARDING THE PRODUCTS UNLESS ABB/JOKAB SAFETY'S ANALYSIS CONFIRMS THAT THE PRODUCTS WERE PROPERLY HANDLED, STORED, INSTALLED, AND MAINTAINED AND NOT SUBJECT TO ABUSE, MISUSE, OR INAPPROPRIATE MODIFICATION OR REPAIR.

SUITABILITY FOR USE

ABB/JOKAB SAFETY shall not be responsible for conformity with any standards, codes, or regulations that apply to the combination of products in the customer's application or use of the product. At the customer's request, ABB/JOKAB SAFETY will provide applicable third party certification documents identifying ratings and limitations of use that apply to the products. This information by itself is not sufficient for a complete determination of the suitability of the products in combination with the end product, machine, system, or other application or use. The following are some examples of applications for which particular attention must be given. This is not intended to be an exhaustive list of all possible uses of the products, nor is it intended to imply that the uses listed may be suitable for the products:

Outdoor use, uses involving potential chemical contamination or electrical interference, or conditions or uses not described in this document.

Nuclear energy control systems, combustion systems, railroad systems, aviation systems, medical equipment, amusement machines, vehicles, and installations subject to separate industry or government regulations.

Systems, machines, and equipment that could present a risk to life or property.

Please know and observe all prohibitions of use applicable to the products.

NEVER USE THE PRODUCTS FOR AN APPLICATION INVOLVING SERIOUS RISK TO LIFE OR PROPERTY WITHOUT ENSURING THAT THE SYSTEM AS A WHOLE HAS BEEN DESIGNED TO ADDRESS THE RISKS, AND THAT THE ABB/JOKAB SAFETY PRODUCT IS PROPERLY RATED AND INSTALLED FOR THE INTENDED USE WITHIN THE OVERALL EQUIPMENT OR SYSTEM.

PERFORMANCE DATA

While every effort has been taken to ensure the accuracy of the information contained in this manual ABB/JOKAB SAFETY cannot accept responsibility for errors or omissions and reserves the right to make changes and improvements without notice. Performance data given in this document is provided as a guide for the user in determining suitability and does not constitute a warranty. It may represent the result of ABB/JOKAB SAFETY'S test conditions, and the users must correlate it to actual application requirements. Actual performance is subject to the ABB/JOKAB SAFETY Warranty and Limitations of Liability.

OVERVIEW

Panic exit device is to be installed on conventional doors with 600-1270mm openings. It can be used for both right- and left-hand doors.

Lever handle is to be installed on the opposite side of the door leaf and it can be locked to prevent access. Although it is possible to open the door from the inside with the panic exit device.

Mounting kit described in this guide are designed to facilitate easy installation on our Quick-Guard fencing system.

Operating temperature:	-10°C to +60
Max door weight:	200 Kg
Max door height:	2500 mm

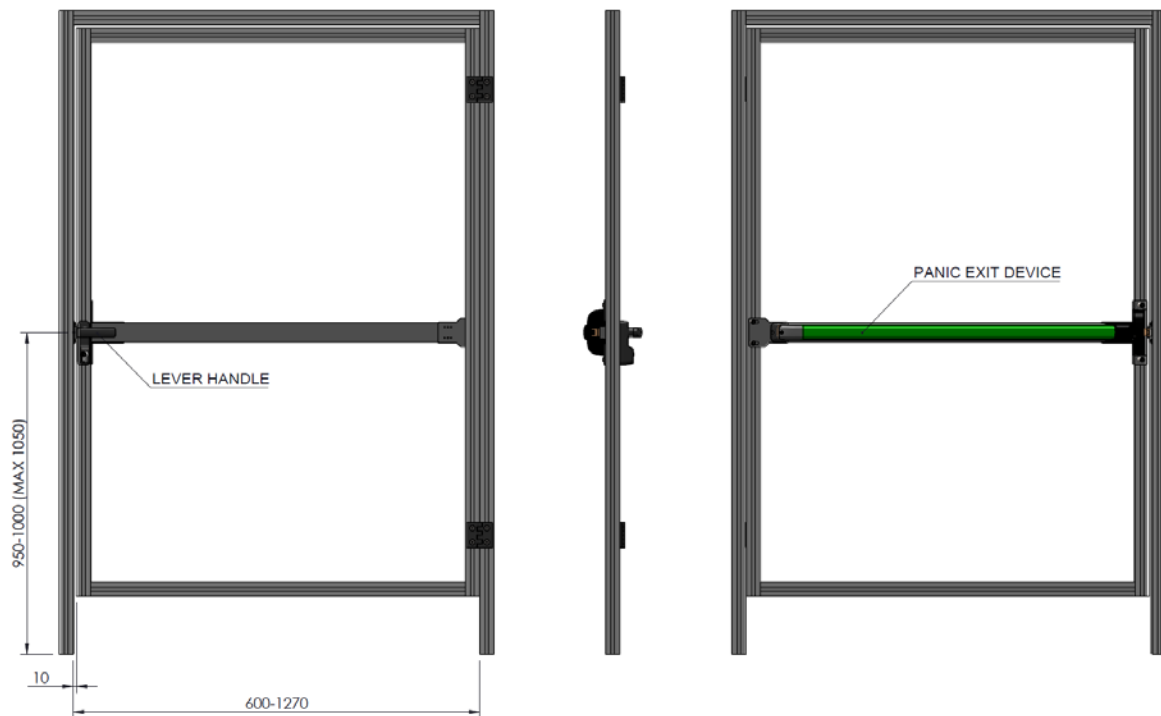

Warning!

Panic exit device nor the lever handle is non-safety products and shall not be used in safety applications, unless the door have an additional safety switch mounted separately.

Panic Exit Device

(Article number 2TLA040033R7000)

Suitable for both right- and left-hand doors, it can be shortened to 330mm.

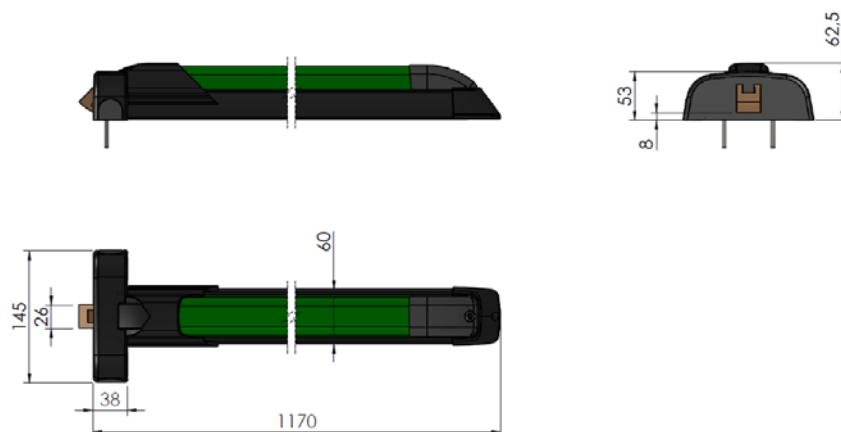

Lever Handle

(Article number 2TLA040033R7100)

Suitable for both right- and left-hand doors. Handle is pre-set for left-hand doors when delivered, it can easily be set for right-hand doors. Door handle is supplied with three (3) keys, write down the key ID-number if spare key has to be ordered later on.

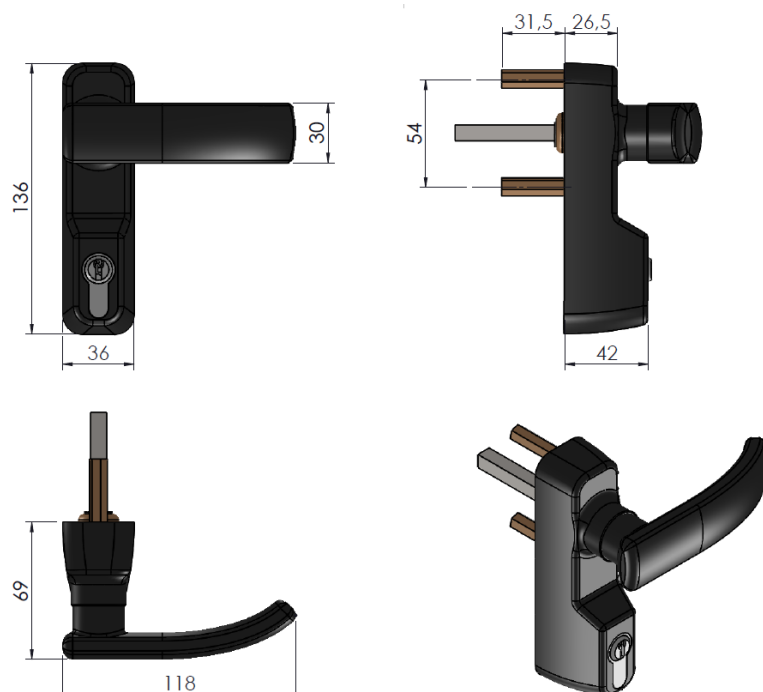

Mounting kit

(Article number 2TLA040033R7200)

All brackets are made in stainless steel and delivered pre-assembled with screws. Brackets are designed to fit Quick-Guard fencing system.

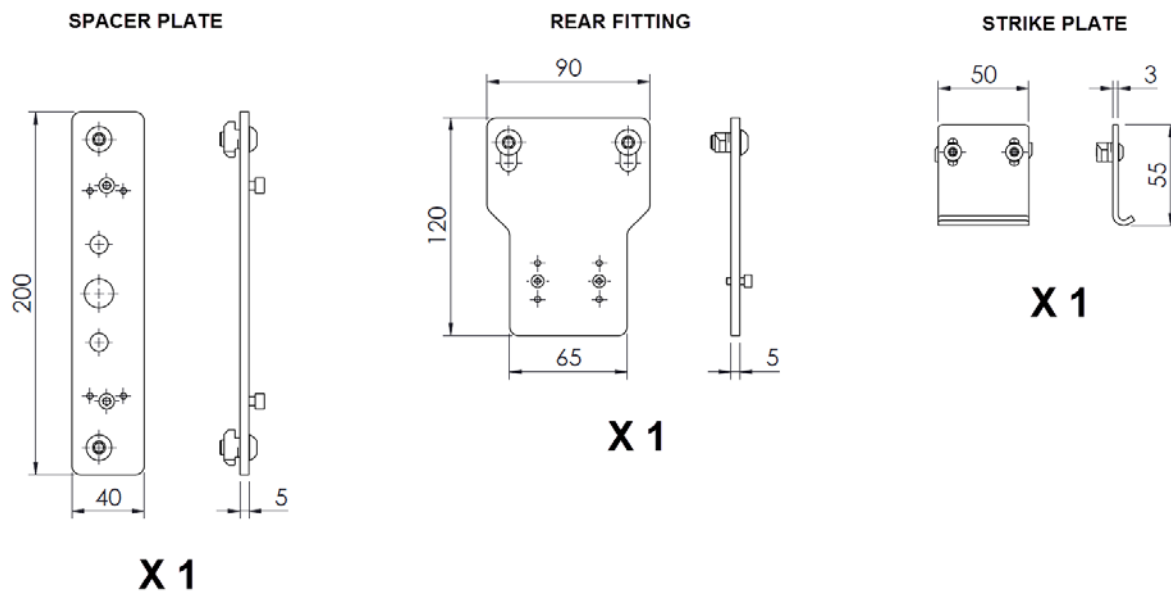

INSTALLATION

Drill hole

Calculate dimension L and drill installation mounting holes in door profile before the door is assembled. Recommended distance from floor level to center of panic exit device is 950-1000mm. Do not exceed 1050mm.

Lever handle shall be installed on the face with the 22 mm hole.

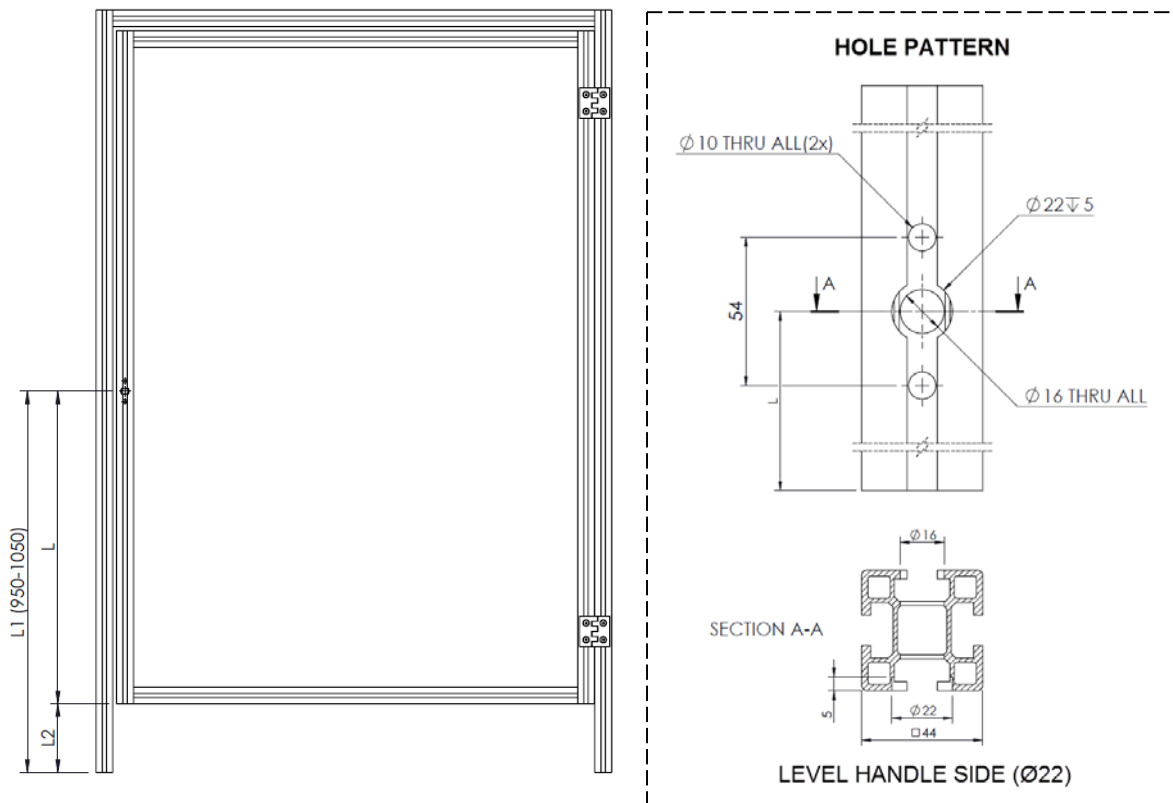

Mount support brackets

Mount spacer fitting on panic exit device side.

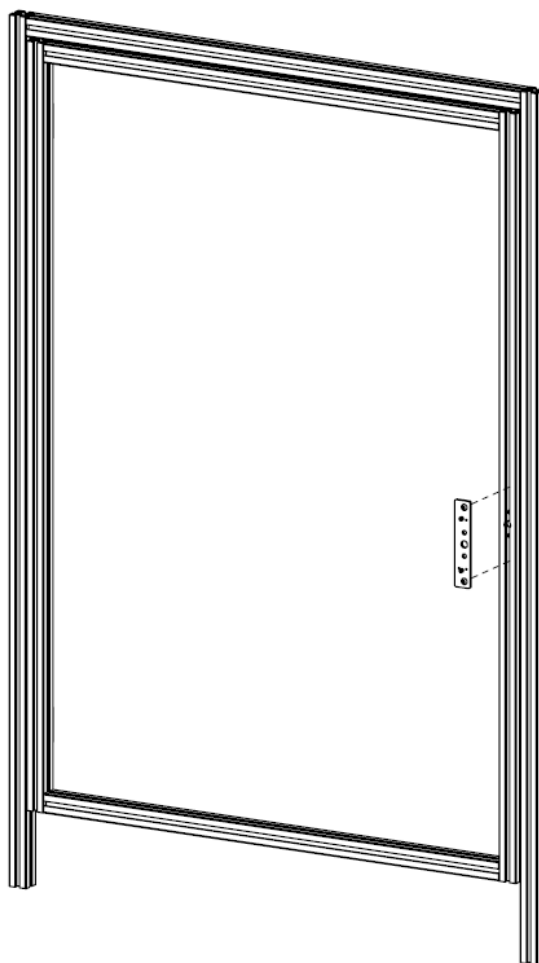
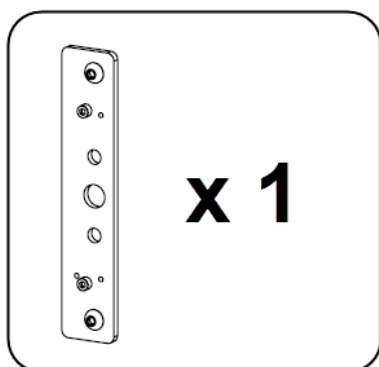

Make sure that spacer fitting is mounted correctly, fitting should not interfere with the gap between the door and the frame. Also it should perfectly line up with the holes in the aluminum profile.

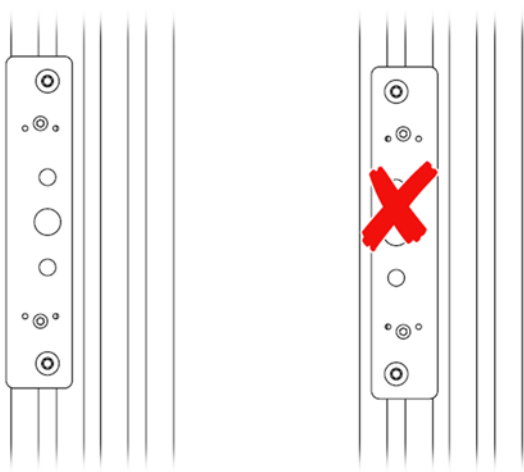

Mount rear support bracket on door frame. It should be positioned at the same height as the spacer bracket.

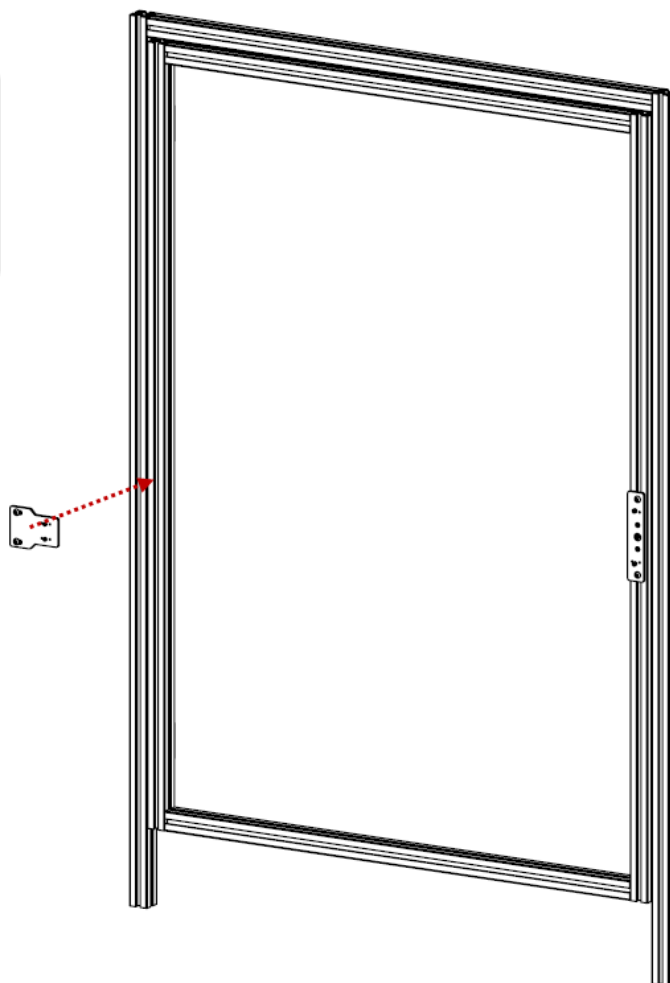
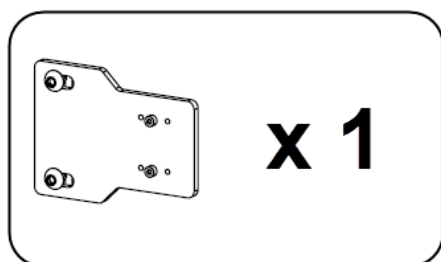

Panic Exit Device.

Adapt the length of the panic exit device to the door width by cutting the aluminum bar and the latch profile. Hold up the panic exit device against the door, make sure that fixing holes in the front match up with holes in the spacer plate, and measure the distance (T) between rear fixing hole and the support bracket. Take the measured distance (T) and cut off the aluminum bar and the latch profile.

Note!

It is possible to adjust the rear support bracket ± 15 mm by changing placement of the fixing screws.

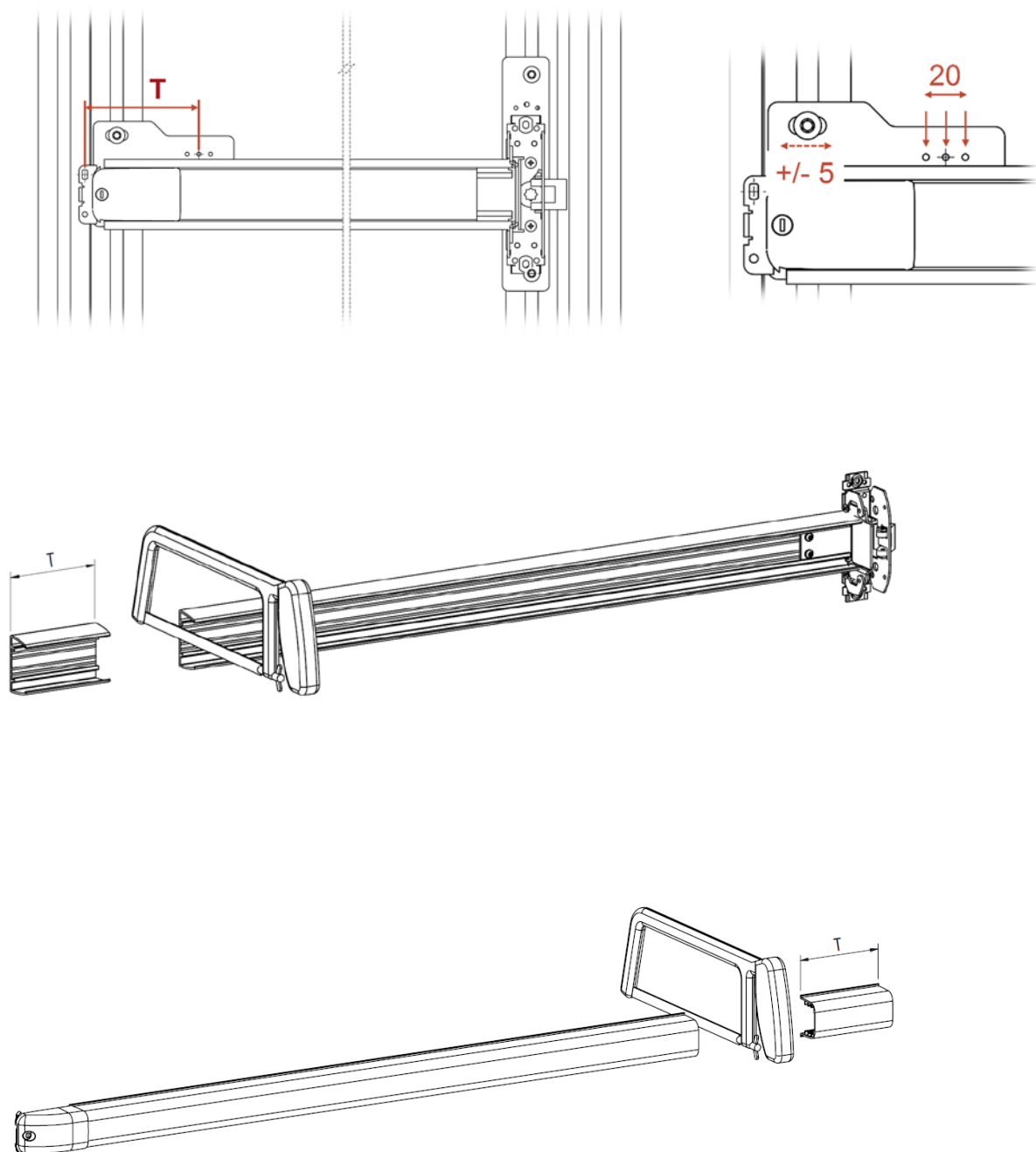

Insert the plastic spacer between the panic exit device and the spacer fitting, and fix the panic exit device with the two M5x8 screws.

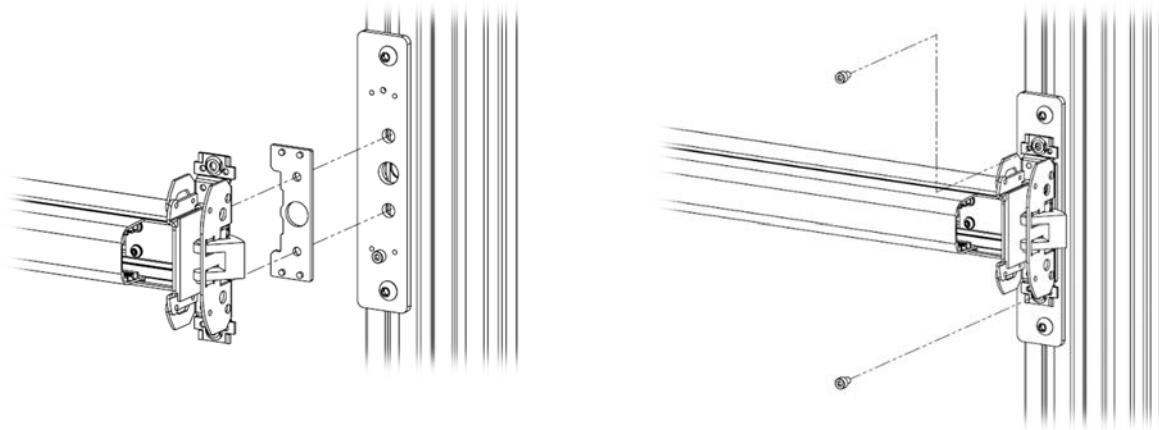

Fix the rear end of the panic exit device with the two M4x10 screws.

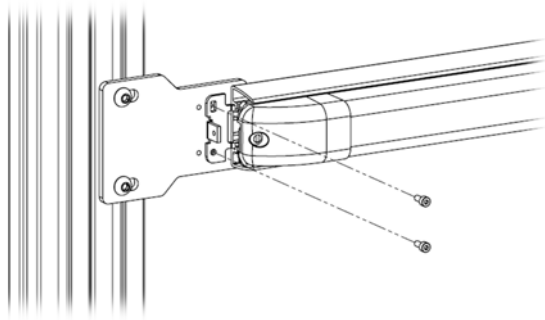

Latch position

Setting the latch position is needed for a good functioning of the lever handle.

Press in the door latch and turn the latch in correct position according to pictures below.

**RIGHT HAND DOOR
(DX)**

**LEFT HAND DOOR
(SX)**

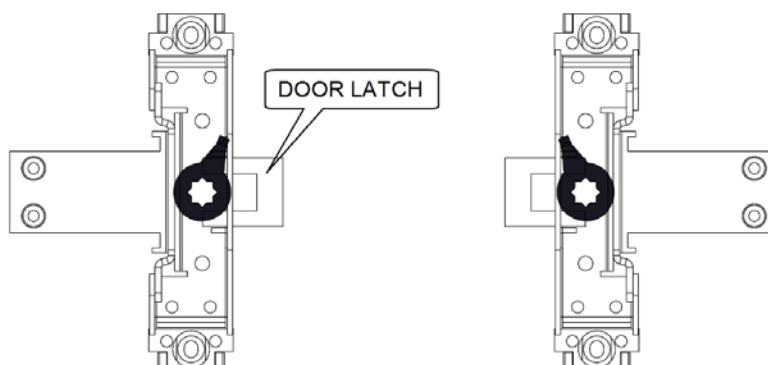

Lever handle

Cut carrier shaft (A) to correct length.

$$L=44+5+16.5= 65,5\text{MM}$$

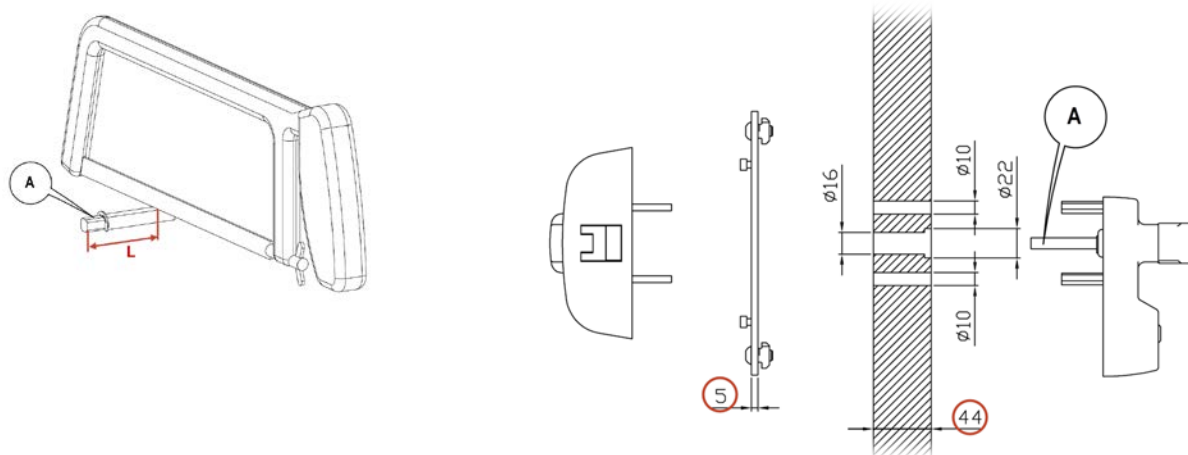

Check if the handle is set for right- or left-hand door and change placement of the settings screw (V1) if needed. Insert the handle to the door and fix it with the two (2) screws. Make sure that handle and panic exit device line up perfectly.

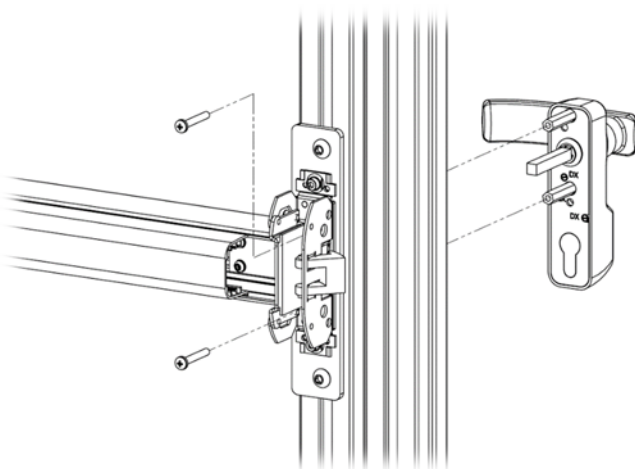

Note!

Cut the two fixing screws to length 35 mm

LEFT HAND DOOR

Place the screw (V1) into the left hole (SX)

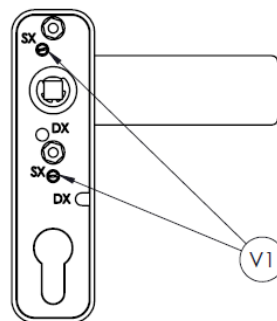

RIGHT HAND DOOR

Place the screw (V1) into the right hole (DX)

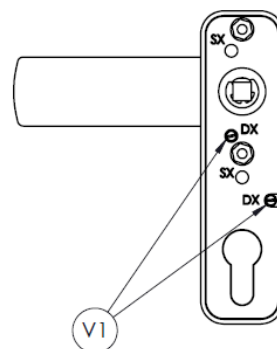

Install the two small cover plates on the front cover.

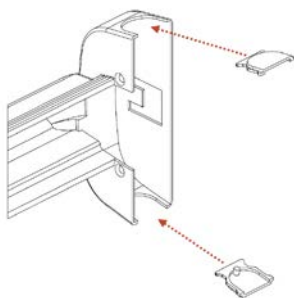

Press the front cover on to the locking mechanism and fix it with two (2) M5 screws

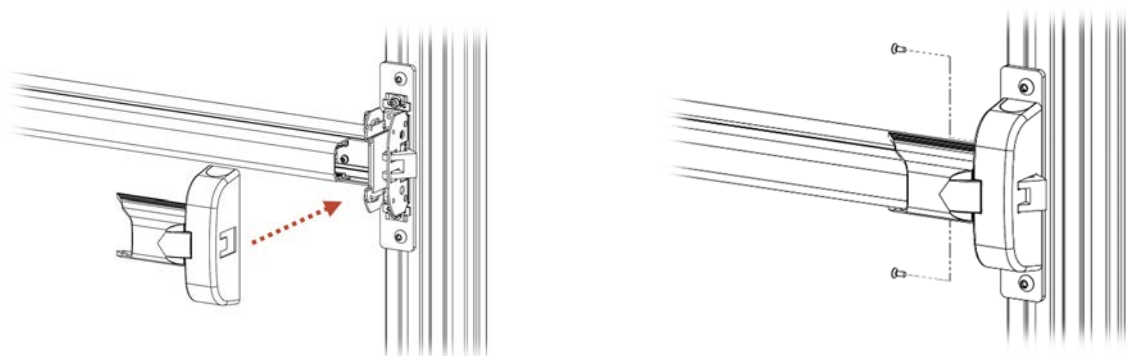

Install the back cover and fix it with one (1) M5 screw. Make sure that cover hooks together with the push bar and secure the cover with the M5 screw.

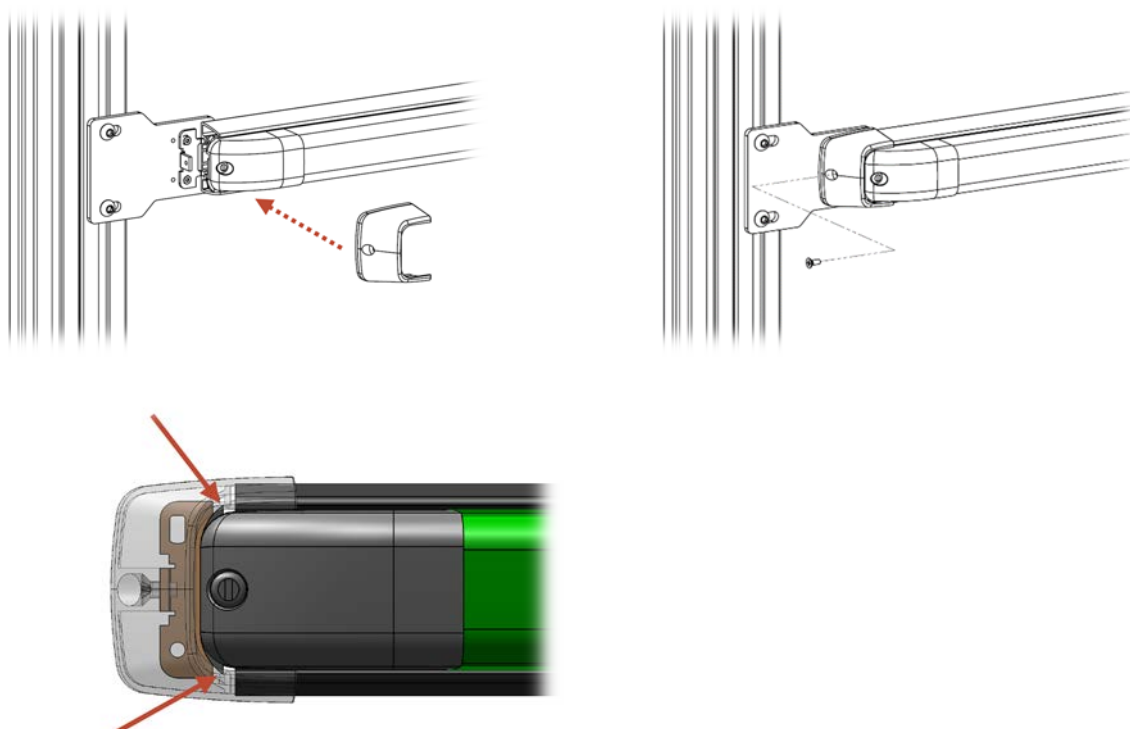

Strike plate

Install the strike plate on the door post. Adjust position of the strike plate until door can be closed and opened easily with the handle, and also opened by the panic exit device.

Note!

To prevent damages on the panic exit device and/or the lever handle, the door must have a separate mechanical door stop, e.g. JSM D13A

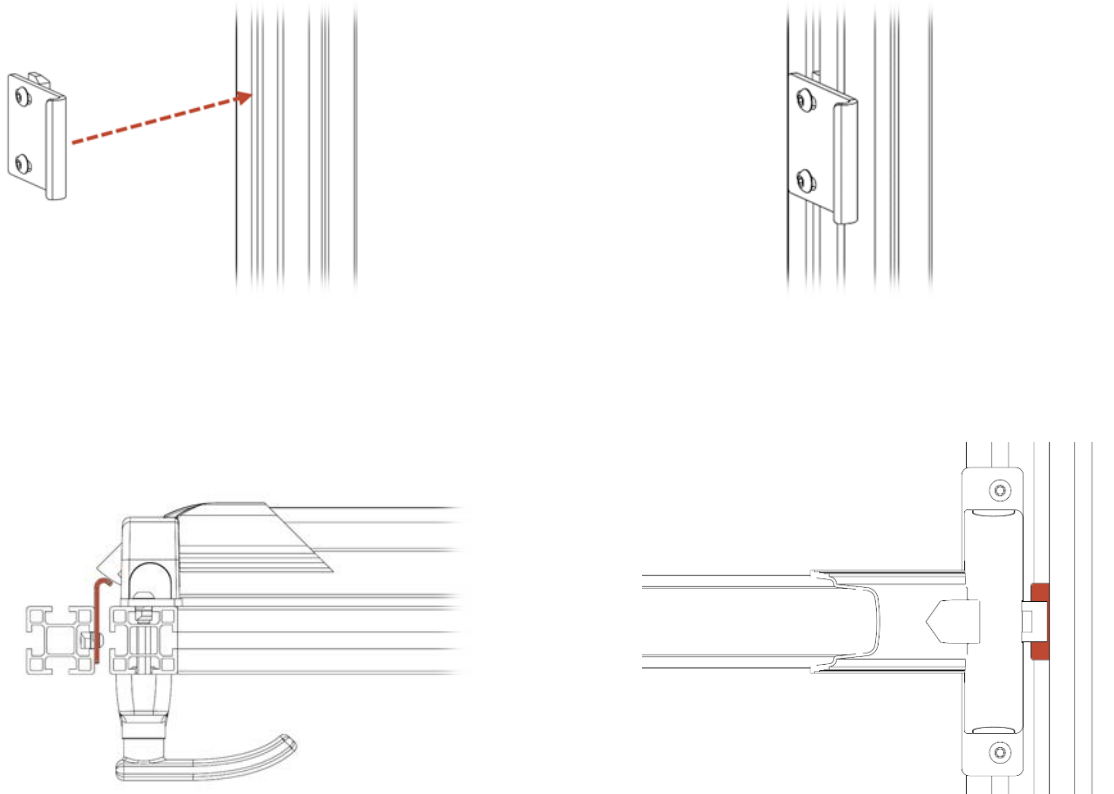

Details – Exploded view

1. Fixing screw - To be cut
2. Plastic spacer
3. Spacer bracket
4. Door profile
5. Carrier shaft – To be cut
6. Lever handle

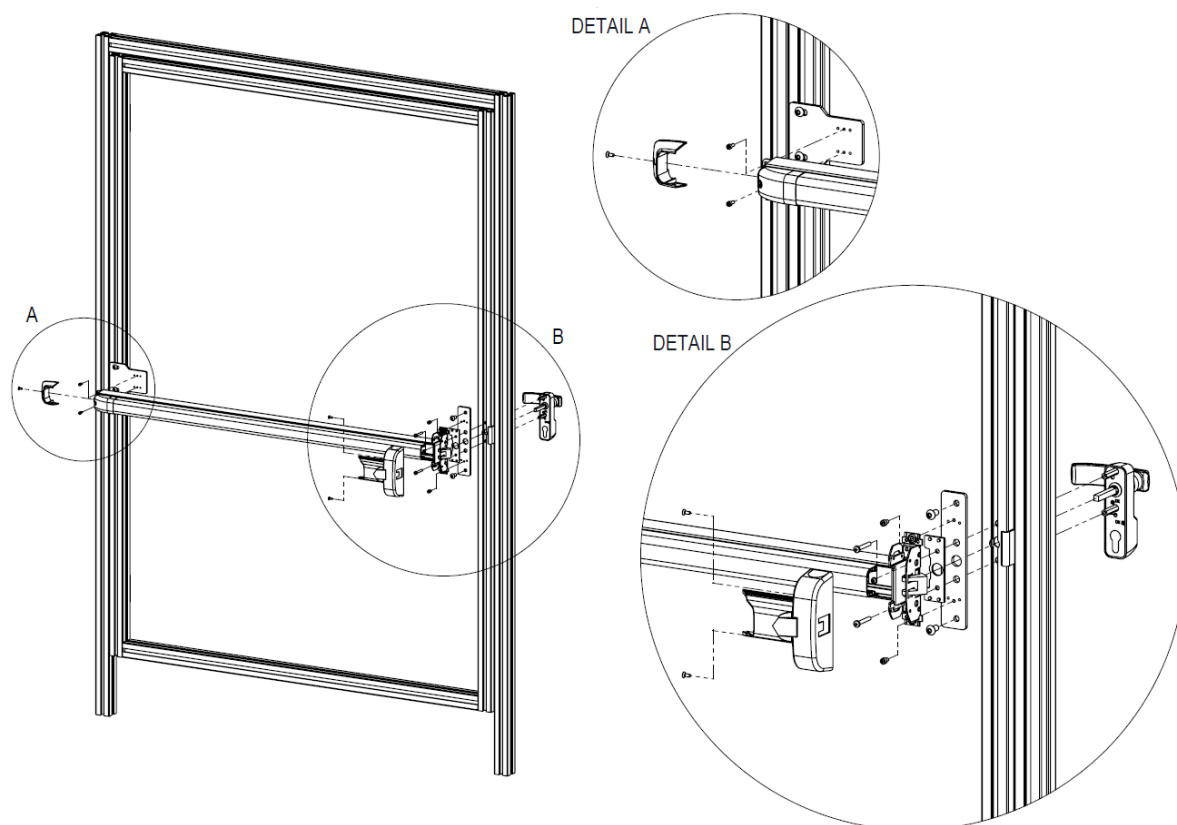
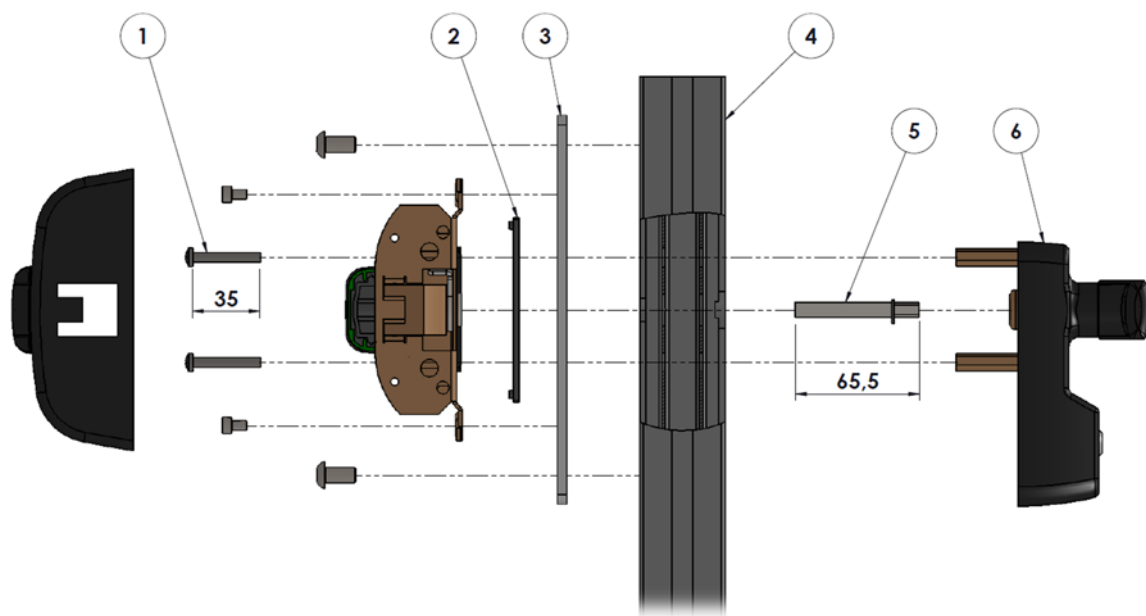

Maintenance

It's recommended that the following routine maintenance checks should be undertaken at intervals of not more than one month by the occupier or his approved representative.

- Inspect and operate the panic exit device to ensure that all components are in satisfactory working condition. In particular check that all screws are tightened.
- Ensure that the strike plate are free from obstruction.
- Check that the contact surfaces of latch and strike plate are well lubricated. Use a grease with a working temperature suitable to the operating conditions.

Technical data

Article number	Name / Description	Material
2TLA040033R7000	Panic Exit Device	Aluminum, black/green powder coated Steel, zinc-plated
2TLA040033R7100	Lever Handle	Zinc, black powder coated
2TLA040033R7200	Mounting kit	Stainless steel